

# **AĞ KAMERASI**

## **Hızlı Kullanma Kılavuzu**

XNV-C9083R/C8083R/C7083R/C6083R  
XND-C9083RV/C8083RV/C7083RV/C6083RV  
XNO-C9083R/C8083R/C7083R/C6083R



## Important

Please check 'Manuals' from our website, before connecting to the Supply,  
<https://www.hanwhavision.com/en/download-data/>

## Warranty

Please check "Product warranty information" from our website.  
<https://www.hanwhavision.com/en/support/warranty/>

We recommend to use the officially compatible VMS version or latest Hanwha NVR version when integrating with VMS or Hanwha NVR.



Hanwha Vision cares for the environment at all product manufacturing stages, and is taking measures to provide customers with more environmentally friendly products.

The Eco mark represents Hanwha Vision's devotion to creating environmentally friendly products, and indicates that the product satisfies the EU RoHS Directive.



### Correct Disposal of This Product (Waste Electrical & Electronic Equipment)

(Applicable in the European Union and other European countries with separate collection systems)

This marking on the product, accessories or literature indicates that the product and its electronic accessories (e.g. charger, headset, USB cable) should not be disposed of with other household waste at the end of their working life. To prevent possible harm to the environment or human health from uncontrolled waste disposal, please separate these items from other types of waste and recycle them responsibly to promote the sustainable reuse of material resources.

Household users should contact either the retailer where they purchased this product, or their local government office, for details of where and how they can take these items for environmentally safe recycling.

Business users should contact their supplier and check the terms and conditions of the purchase contract. This product and its electronic accessories should not be mixed with other commercial wastes for disposal.



### Correct disposal of batteries in this product

(Applicable in the European Union and other European countries with separate battery return systems.)

This marking on the battery, manual or packaging indicates that the batteries in this product should not be disposed of with other household waste at the end of their working life. Where marked, the chemical symbols Hg, Cd or Pb indicate that the battery contains mercury, cadmium or lead above the reference levels in EC Directive 2006/66. If batteries are not properly disposed of, these substances can cause harm to human health or the environment.

To protect natural resources and to promote material reuse, please separate batteries from other types of waste and recycle them through your local, free battery return system.

## SAFETY INFORMATION

---



**Dış Mekan Vandal Dom Kamera**

XNV-C9083R/C8083R/  
C7083R/C6083R

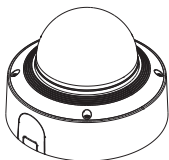

**İç Mekan Dom Kamera**

XND-C9083RV/C8083RV/  
C7083RV/C6083RV

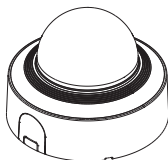

**Dış Mekan Mermi Kamera**

XNO-C9083R/C8083R/  
C7083R/C6083R

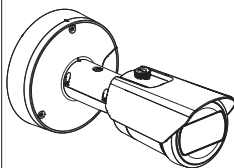



## COMPONENT

---

Satış yapılan her ülkede aksesuar aynı değildir.

- XNV-C9083R/XNV-C8083R/XNV-C7083R/XNV-C6083R

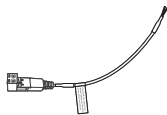
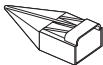
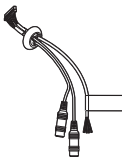
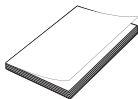
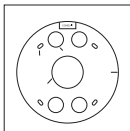
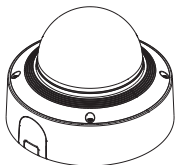

# INSTALLATION

1

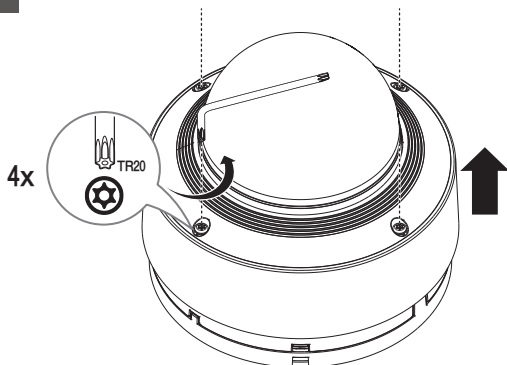

2

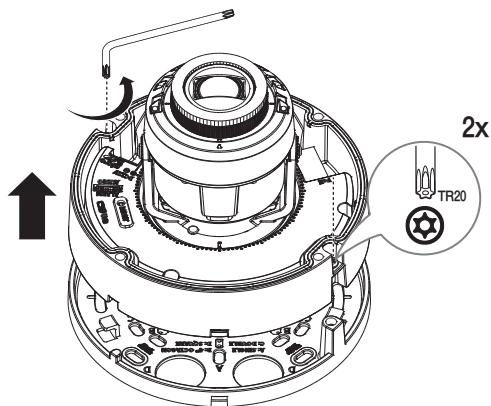

## INSTALLATION

3

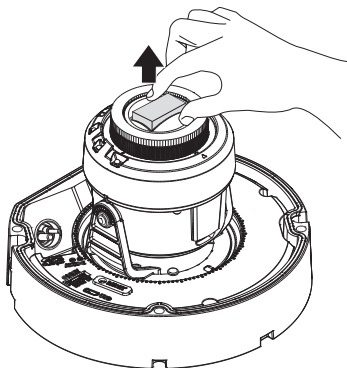

4

- Dahil Değil : Micro SD kartı

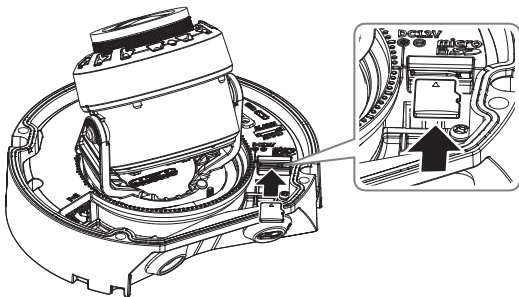

# INSTALLATION

5

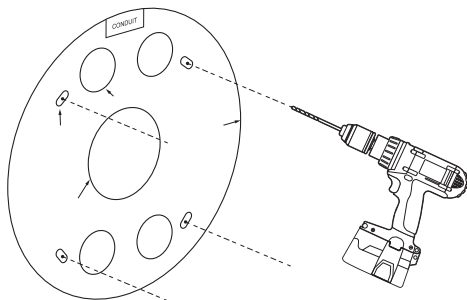

6-1

• Doğrudan duvara/tavana montaj

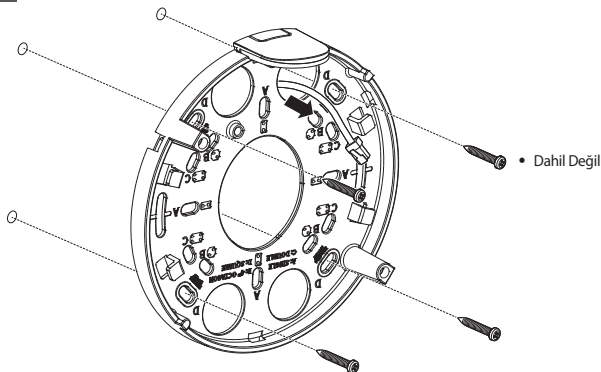

## INSTALLATION

6-2

- Kabloyu yan taraftan bağlarken

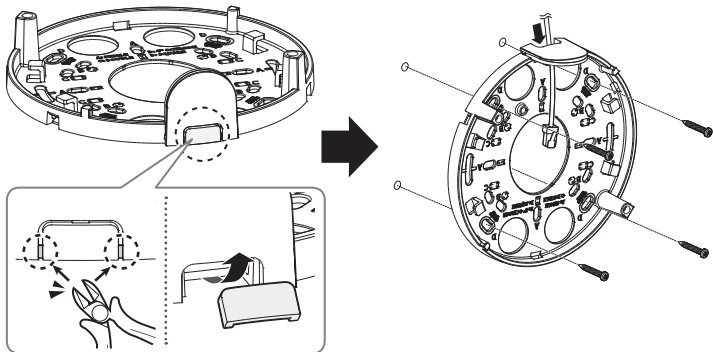

7-1

- Boru aracılığıyla montaj

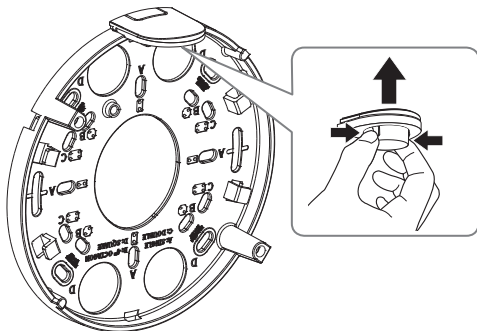

## INSTALLATION

7-2

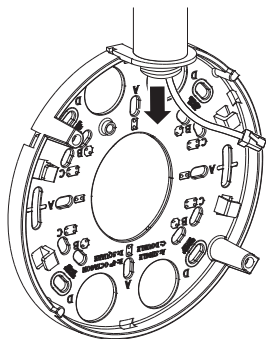

8-1

- Ağ/güç kablolarının takılması

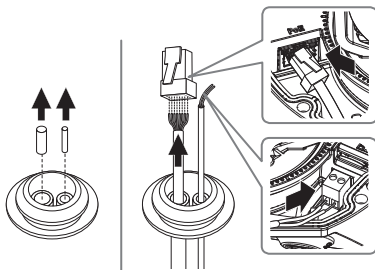

## INSTALLATION

8-2

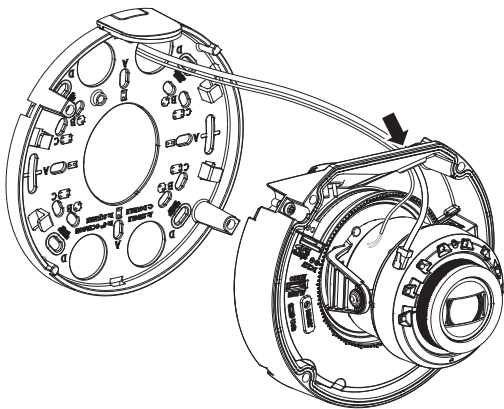

9-1

- Ağ kablosunun takılması (PoE)

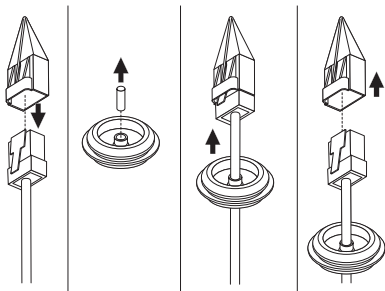

## INSTALLATION

9-2

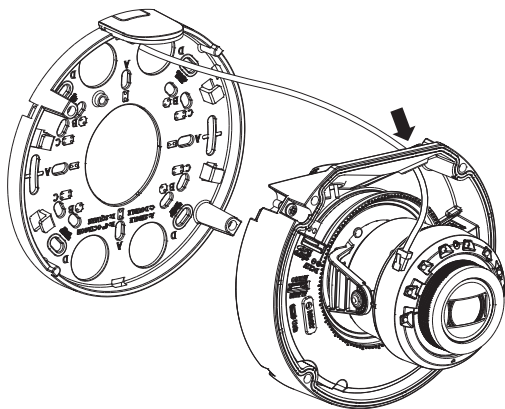

10

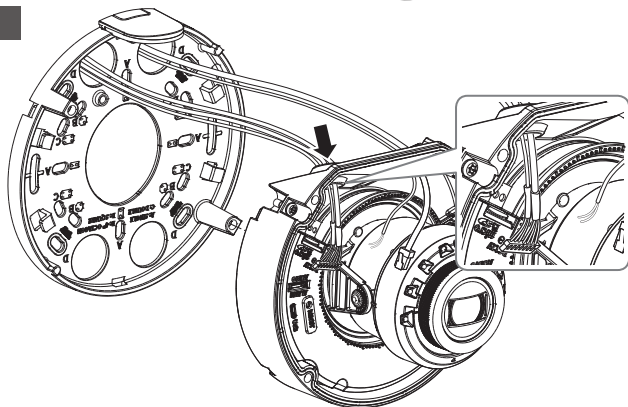



## INSTALLATION

11

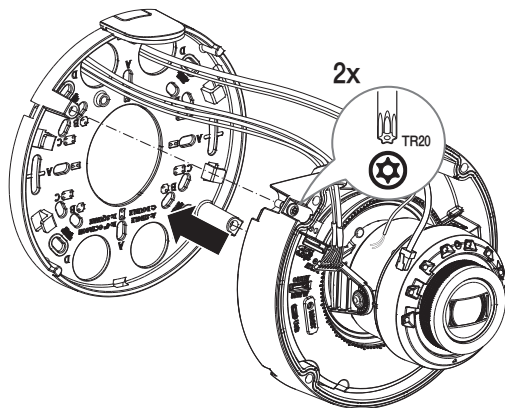

## INSTALLATION

12

- Dahil Değil: WiFi dongle, OTG adaptör

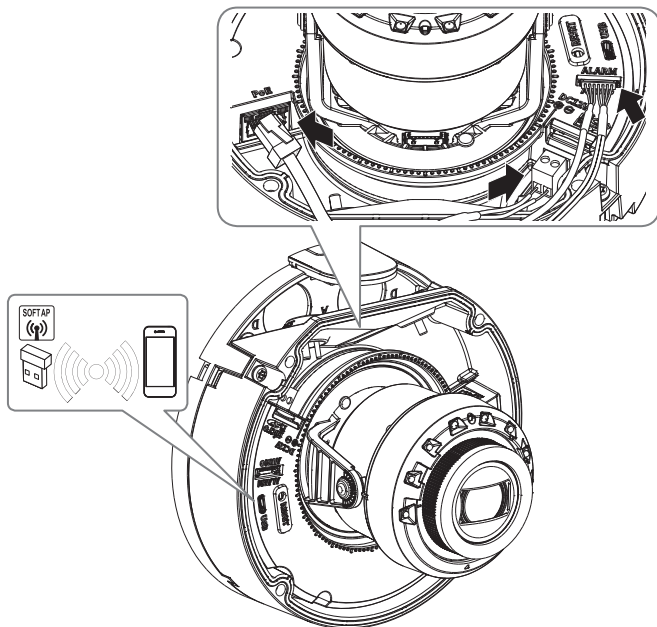

## INSTALLATION

13



14

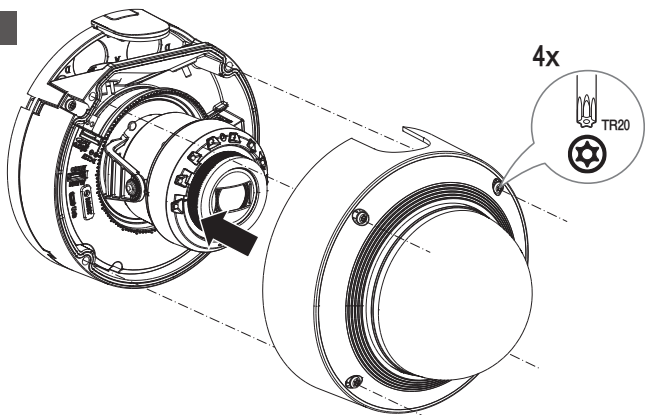

15

## INSTALLATION

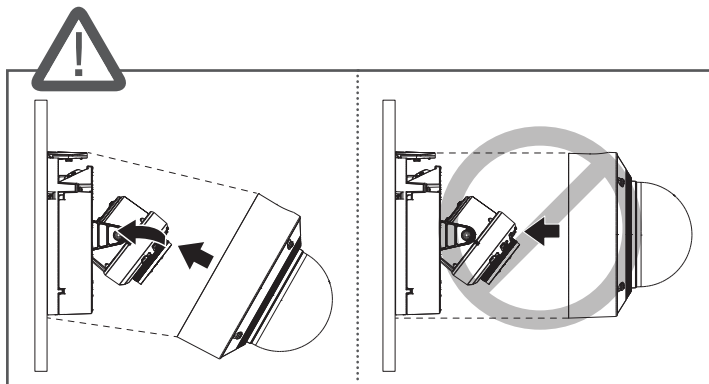

15



16

## COMPONENT

Satış yapılan her ülkede aksesuar aynı değildir.

- XND-C9083RV/XND-C8083RV/XND-C7083RV/XND-C6083RV

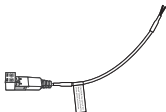
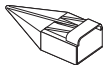
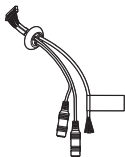
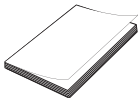
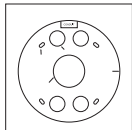
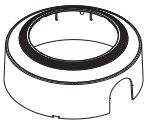
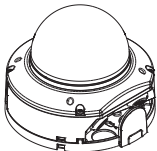

# INSTALLATION

1

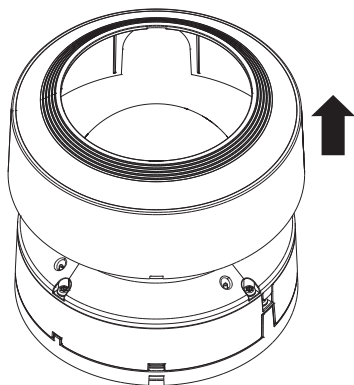
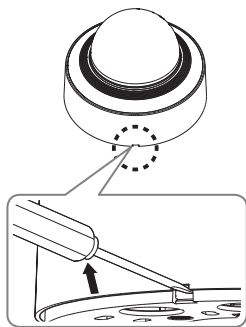

2

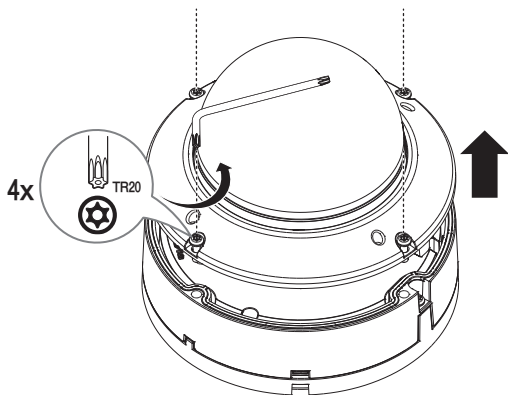

## INSTALLATION

3

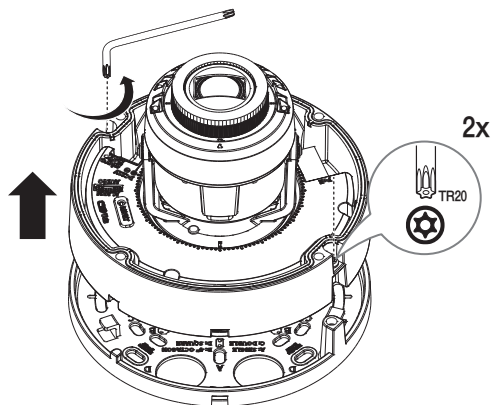

4

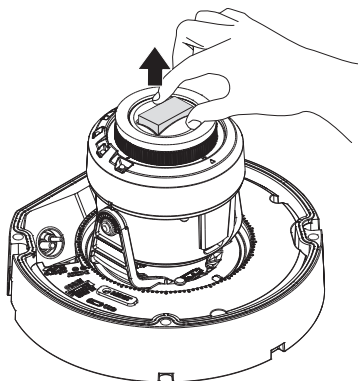

## INSTALLATION

5

- Dahil Değil : Micro SD kartı

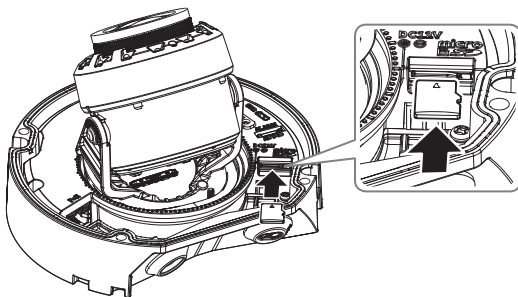

6

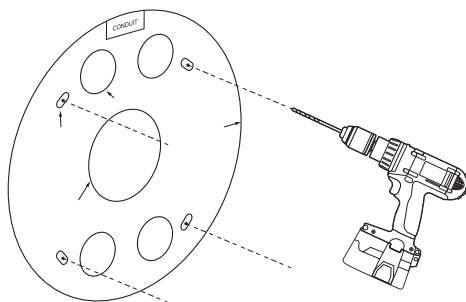



## INSTALLATION

7-1

- Doğrudan duvara/tavana montaj

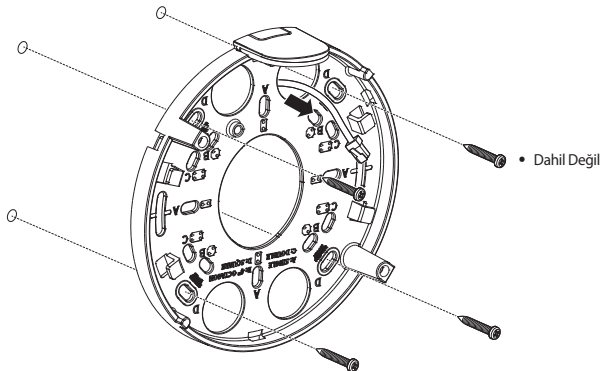

7-2

- Kabloyu yan taraftan bağlarken

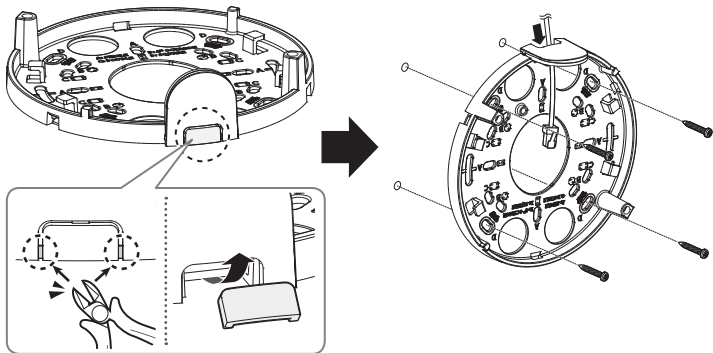

## INSTALLATION

8-1

- Boru aracılığıyla montaj

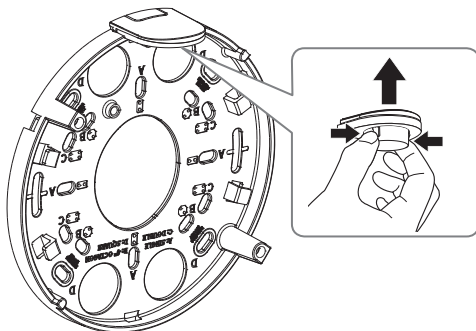

8-2

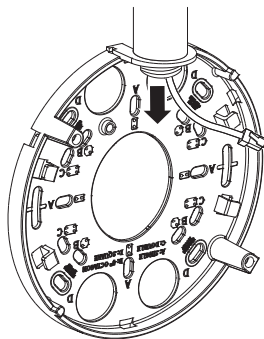

## INSTALLATION

9-1

- Ağ/güç kablolarının takılması

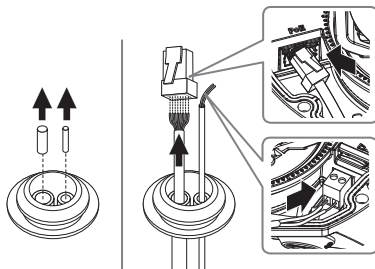

9-2

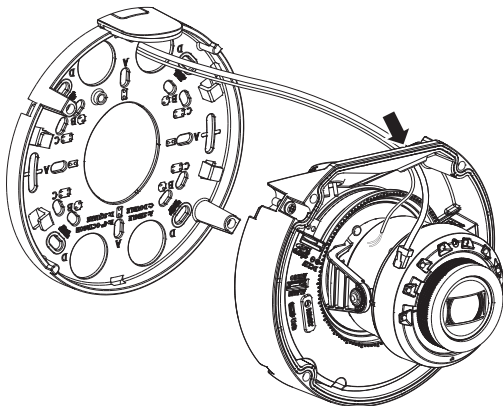

## INSTALLATION

10-1

- Ağ kablosunun takılması (PoE)

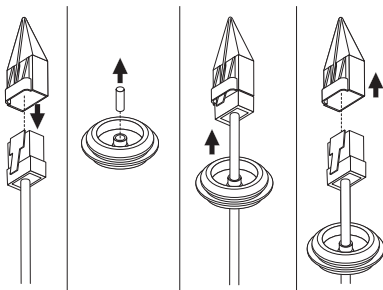

10-2

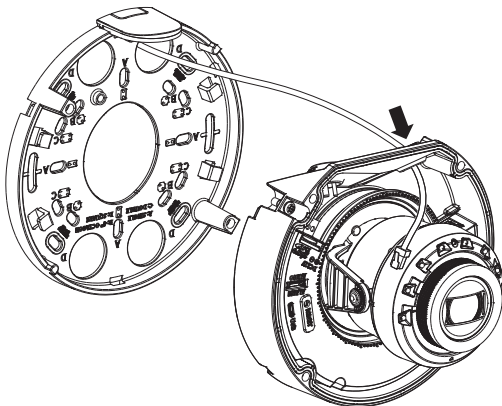

## INSTALLATION

11

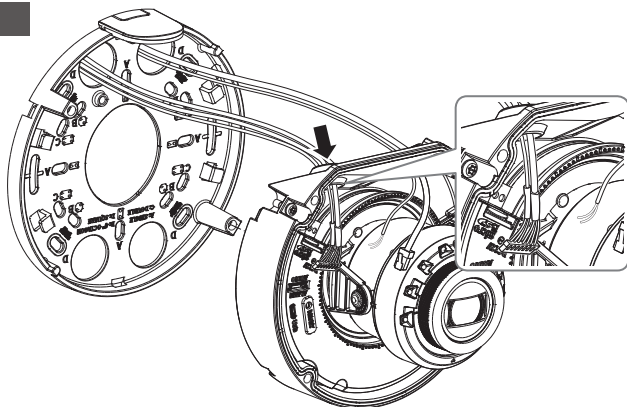

12

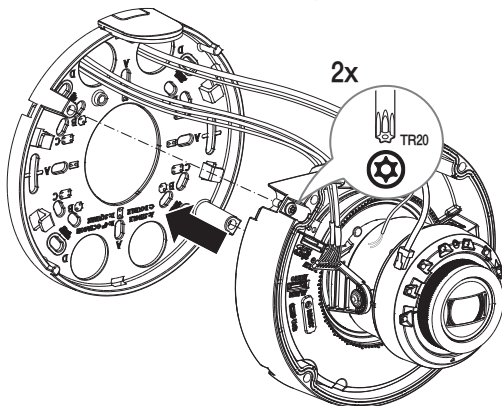

## INSTALLATION

13

- Dahil Değil: WiFi dongle, OTG adaptör

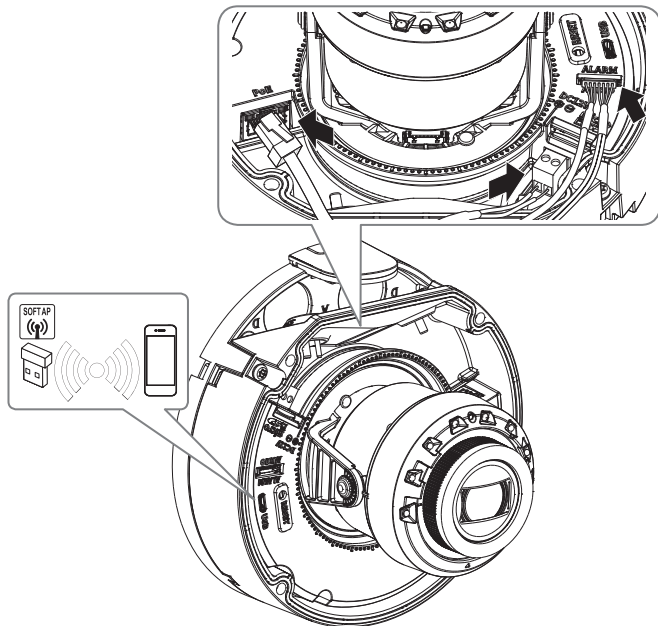

## INSTALLATION

14



15

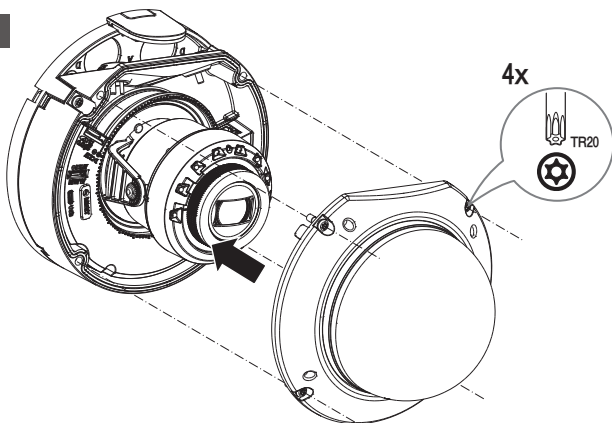

## INSTALLATION

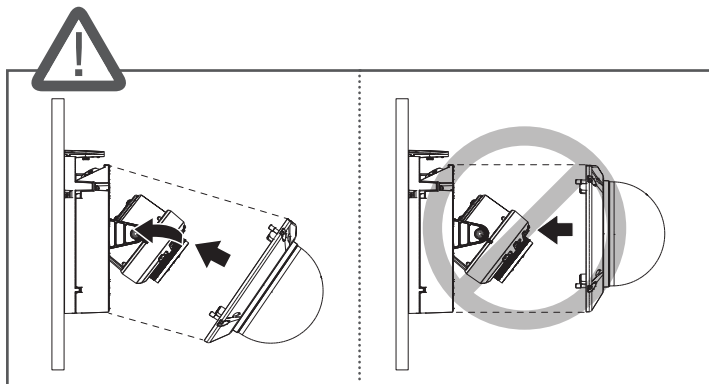

16

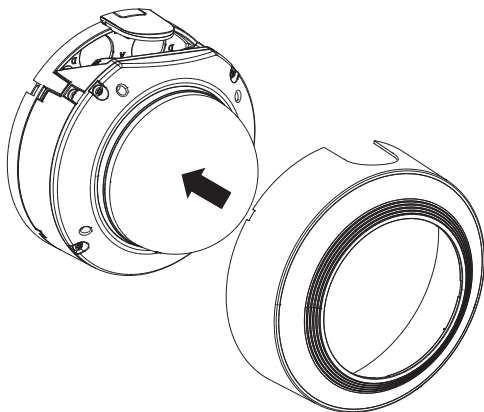





## INSTALLATION

---

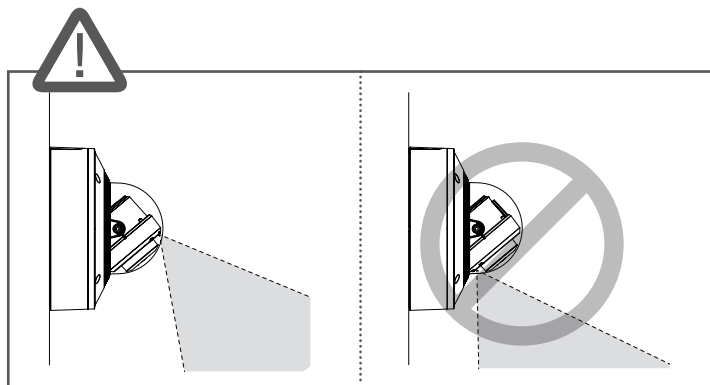

## COMPONENT

Satış yapılan her ülkede aksesuar aynı değildir.

- XNO-C9083R/XNO-C8083R/XNO-C7083R/XNO-C6083R

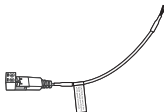
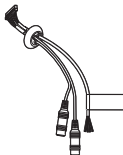
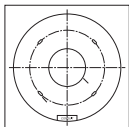
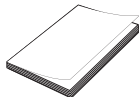
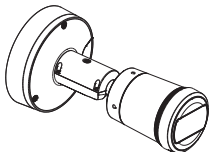

## INSTALLATION

1

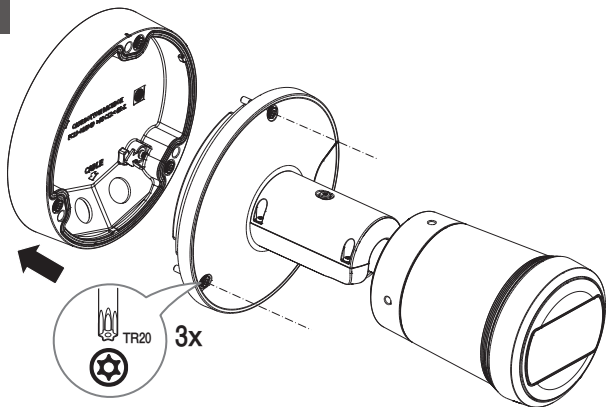

2

- Dahil Değil : Micro SD kartı

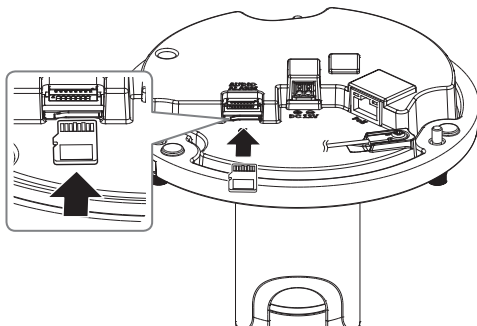

## INSTALLATION

3

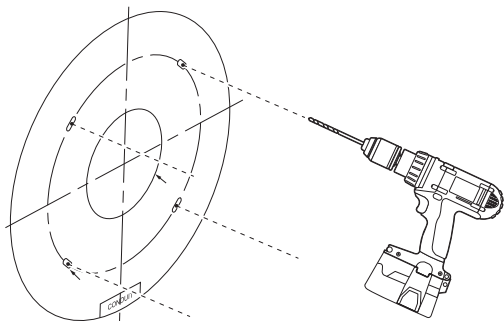

4

- Doğrudan duvara/tavana montaj

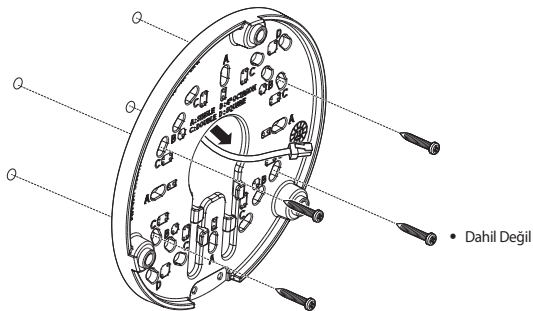

## INSTALLATION

5-1

- Boru aracılığıyla montaj

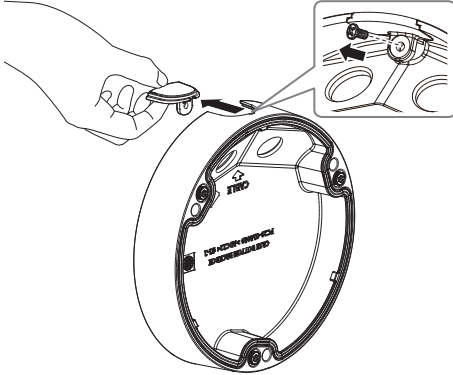

5-2

- 1 Seçenekler (Dahil Değil)

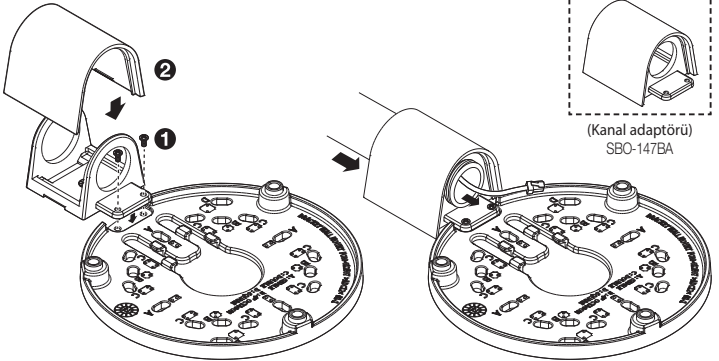

(Kanal adaptörü)  
SBO-147BA

## INSTALLATION

6-1

- Ağ/güç kablolarının takılması

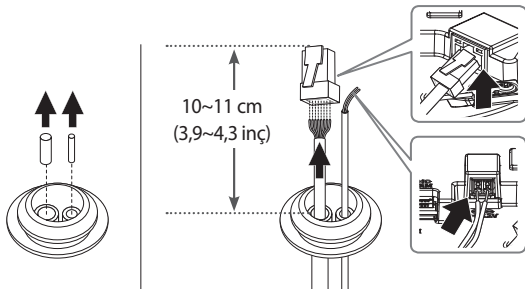

6-2

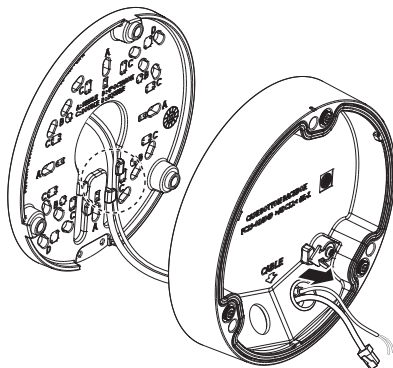

## INSTALLATION

7-1

- Ağ kablosunun takılması (PoE)

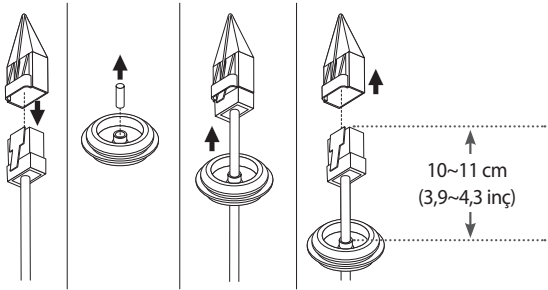

7-2

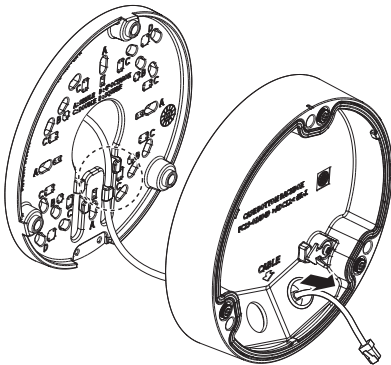



## INSTALLATION

8

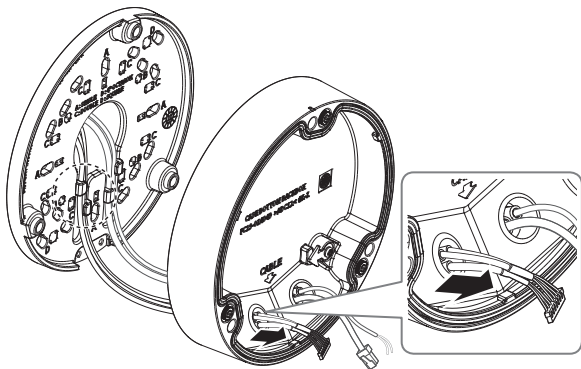

9

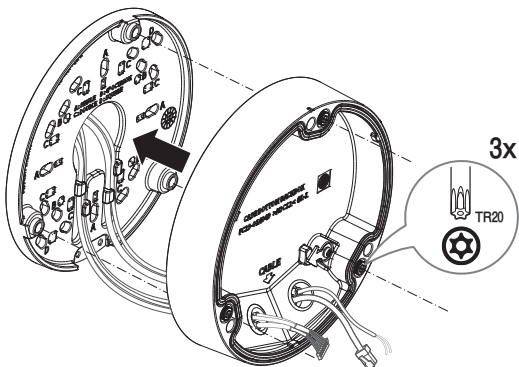

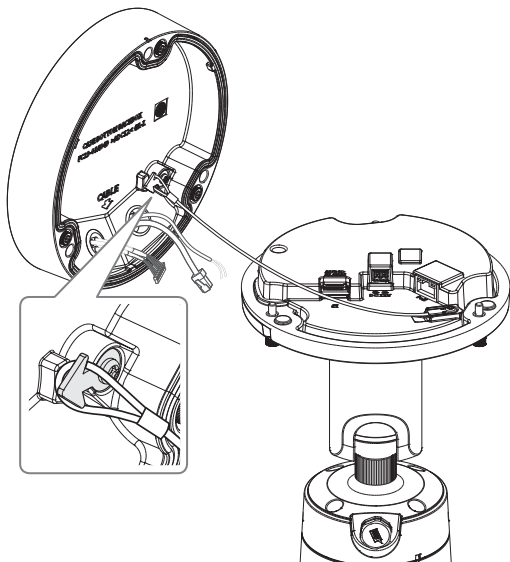

## INSTALLATION

11

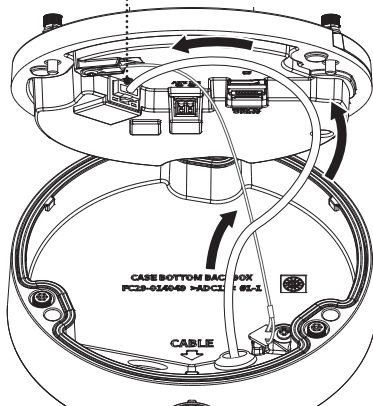
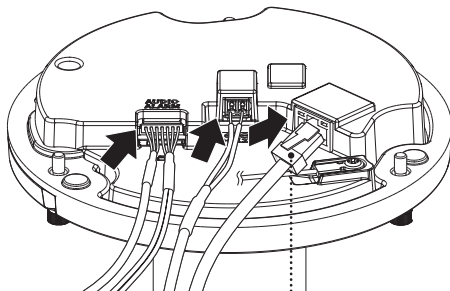

## INSTALLATION

12

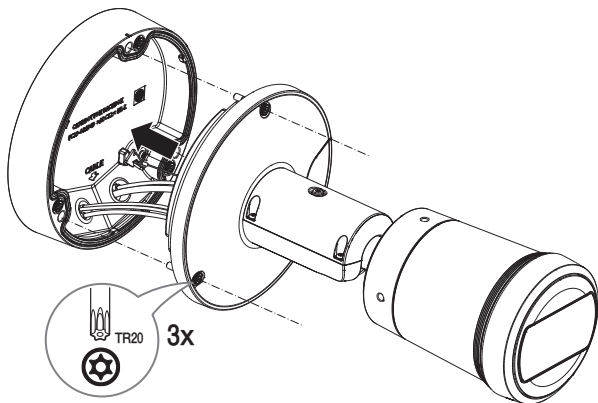

13

- Dahil Değil: WiFi dongle, OTG adaptör

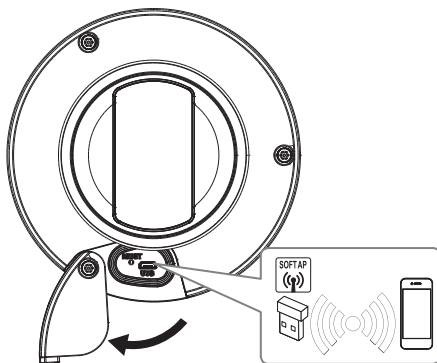

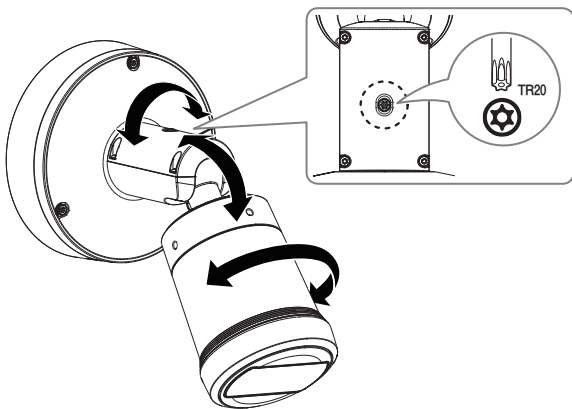

## INSTALLATION

16

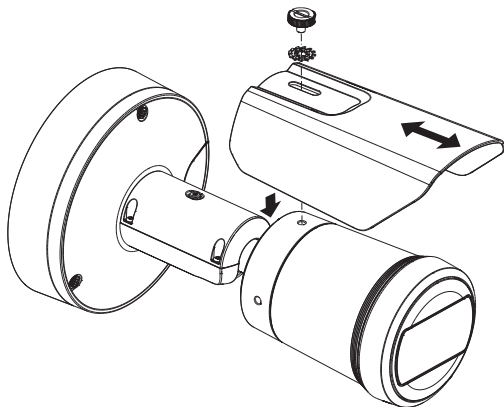

17



## ŞİFRE AYARI

Ürüne ilk kez erişim sağladığınızda, oturum açma şifresini yaratmanız gerekir.

Administrator password change

New password

Confirm new password

- If the password is 8 to 9 characters long, then it must include a combination of at least 3 of the following character types: alphabet letters with uppercase or lowercase, numbers, and special characters.
- If the password is longer than 10 characters, then it must include a combination of at least 2 of the following character types: alphabet letters with uppercase or lowercase, numbers, and special characters.
- User name may not be used as password.
- The following special characters can be used: ~!@#\$%^&\*()\_+=|{}[]?/
- You may not use more than 4 consecutive characters. (example: 1234, abcd, etc.)
- You may not use the same character 4 or more times consecutively. (example: 1111, aaaa, etc.)

Apply



- 8 ile 9 haneli yeni bir şifrede, şunlardan en az üçünü kullanmanız gerekir: büyük/küçük harfler, sayılar ve özel karakterler. 10 ile 15 haneli bir şifrede, yukarıda belirtilen türlerden en az ikisini kullanmanız gerekir.
- İzin verilen özel karakterler: ~!@#\$%^&\*()\_+=|{}[]?/
- Daha üst seviyede güvenlik için şifrelerinizde aynı karakterlerin veya ardışık klavye girişlerinin tekrarlanması önerilir.
- Şifrenizi kaybettiyseniz, ürünü sıfırlamak için **[RESET]** düğmesine basabilirsiniz. Bir deftere not ederek ya da ezberleyerek şifrenizi kaybetmeyin.

## OTURUM AÇMA

Kameraya her erişiminiz sırasında oturum açma penceresi görünür.

Kameraya erişmek için Kullanıcı Kimliği'ni ve şifrenizi girin.

- 1 <User Name> giriş kutusuna "admin" yazın.
- 2 Şifreyi <Password> giriş alanına girin.
- 3 [Sign in] ögesine tıklayın.

## Wi-Fi'YE BAĞLANMA

### Kamera ayarı

- 1 OTG adaptörünü (5 pimli) ve Wi-Fi dongle'ını mikro USB terminaline bağlayın.

### Akıllı telefon ayarı

- 1 Wisenet kurulum uygulamasını yükleyin.
- 2 Wi-Fi'yi açtıktan sonra kamera SSID'sini seçin.
- 3 Wisenet kurulum uygulamasını çalıştırın.
- 4 Kameraya oturum açtığınızda görüntü bağlantısı kurulur.
  - Bağlantı açıldığında, görüntüler oturum açılmadan oynatılır.
- 5 Akıllı telefonunuz üzerinden görüntüleri izlerken görüş açısını ayarlayabilirsiniz.



microSD, microSDHC, and microSDXC Logos are trademarks of SD-3C LLC. microSD, microSDHC, microSDXC are trademarks or registered trademarks of SD-3C, LLC in the United States, other countries or both.



Подлежит использованию по назначению  
в нормальных условиях  
Срок службы : 7 лет.

## **Türkiye Distribütörü**

**EDS Elektronik Destek Sanayi ve Ticaret Ltd. Şti.**

Meclis Mah. Teraziler Cad. Hayran Sk. (Eskisi Kılıç Sk.) No: 4 Sancaktepe / İstanbul / Türkiye  
Tel +90.216.313.25.15

**ENTES ELEKTRONİK CİHAZLAR İMALAT VE TİC. A.Ş.**

Dudullu Org.San.Bölg. 1. Cad. No:23 34776 Ümraniye / İstanbul / Türkiye  
Tel +90.216.313.01.10

**TEKNOMAKS TEKNOLOJİ / TEKNOMAKS BİLİSİM**

MERDİVENKÖY MAH.DİKYOL SOK. BUSINESS İSTANBUL No:2, Kat:7, D:B67, 34732 Kadıköy / İstanbul / Türkiye  
Tel +90.212.217.54.22

Cihazın Ticaret Bakanlığına önerilen ortalama ömrü  
Cihazın EEE yönetmeliklerine uygun olduğuna benzer beyan



