

SÍŤOVÁ KAMERA

Stručná příručka

XNV-6083R/XNV-8082R/XNV-8083R/
XNV-8093R/XNV-9082R/XNV-9083R/
XND-6083RV/XND-8082RV/XND-8083RV/
XND-8093RV/XND-9082RV/XND-9083RV/
XND-8082RF/XND-9082RF



Important

Please check 'Manuals' from our website, before connecting to the Supply,
<https://www.hanwhavision.com/en/download-data/>

Warranty

Please check "Product warranty information" from our website.
<https://www.hanwhavision.com/en/support/warranty/>

We recommend to use the officially compatible VMS version or latest Hanwha NVR version when integrating with VMS or Hanwha NVR.



Hanwha Vision cares for the environment at all product manufacturing stages, and is taking measures to provide customers with more environmentally friendly products. The Eco mark represents Hanwha Vision's devotion to creating environmentally friendly products, and indicates that the product satisfies the EU RoHS Directive.



Correct Disposal of This Product (Waste Electrical & Electronic Equipment)

(Applicable in the European Union and other European countries with separate collection systems)

This marking on the product, accessories or literature indicates that the product and its electronic accessories (e.g. charger, headset, USB cable) should not be disposed of with other household waste at the end of their working life. To prevent possible harm to the environment or human health from uncontrolled waste disposal, please separate these items from other types of waste and recycle them responsibly to promote the sustainable reuse of material resources.

Household users should contact either the retailer where they purchased this product, or their local government office, for details of where and how they can take these items for environmentally safe recycling.

Business users should contact their supplier and check the terms and conditions of the purchase contract. This product and its electronic accessories should not be mixed with other commercial wastes for disposal.



Correct disposal of batteries in this product

(Applicable in the European Union and other European countries with separate battery return systems.)

This marking on the battery, manual or packaging indicates that the batteries in this product should not be disposed of with other household waste at the end of their working life. Where marked, the chemical symbols Hg, Cd or Pb indicate that the battery contains mercury, cadmium or lead above the reference levels in EC Directive 2006/66. If batteries are not properly disposed of, these substances can cause harm to human health or the environment.

To protect natural resources and to promote material reuse, please separate batteries from other types of waste and recycle them through your local, free battery return system.

SAFETY INFORMATION



Venkovní bezpečnostní
kopulovitá kamera

XNV-6083R/XNV-8082R/
XNV-8083R/XNV-8093R/
XNV-9082R/XNV-9083R

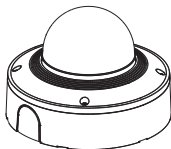

Vnitřní bezpečnostní kopulovitá
kamera

XND-6083RV/XND-8082RV/
XND-8083RV/XND-8093RV/
XND-9082RV/XND-9083RV

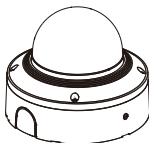

Vestavěná kopulovitá kamera

XND-8082RF/XND-9082RF

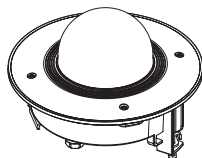

COMPONENT

Příslušenství není pro všechny země prodeje stejné.

- XNV-6083R/XNV-8082R/XNV-8083R/XNV-8093R/XNV-9082R/XNV-9083R

* Tvar modulu se může u jednotlivých produktů lišit.

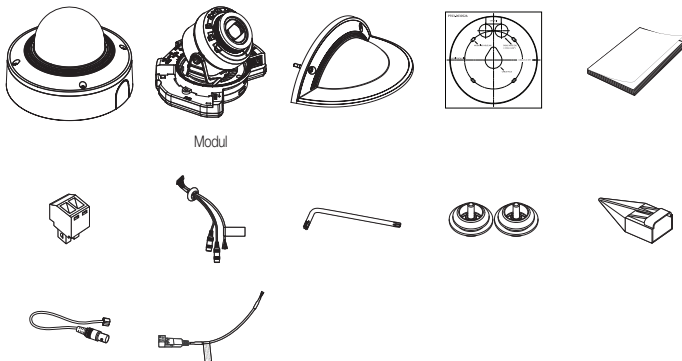

i Možnosti (nejsou uvedeny)

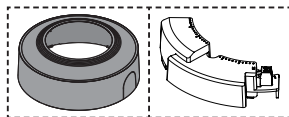

SBC-180B
(Barva: černá)

SPC-100AC
Pouze XNV-8082R/
XNV-9082R

INSTALLATION

1

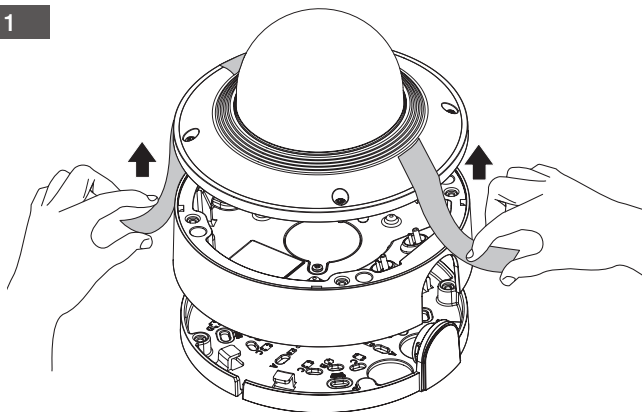

2

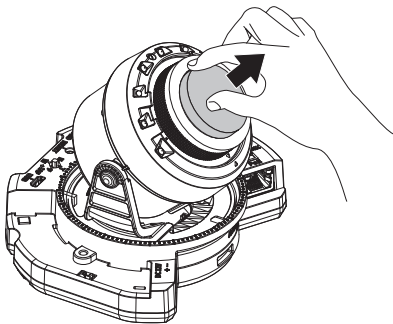

INSTALLATION

3

- Nezahmuto: Micro SD karta

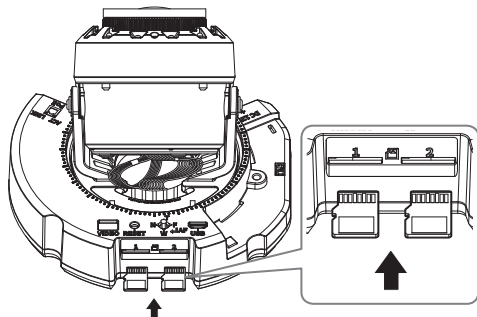

4

- Nezahmuto: SPC-100AC (Pouze XNV-8082R/XNV-9082R)

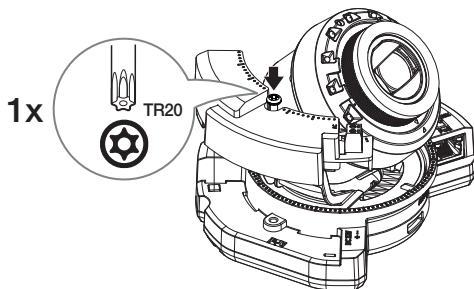

INSTALLATION

5

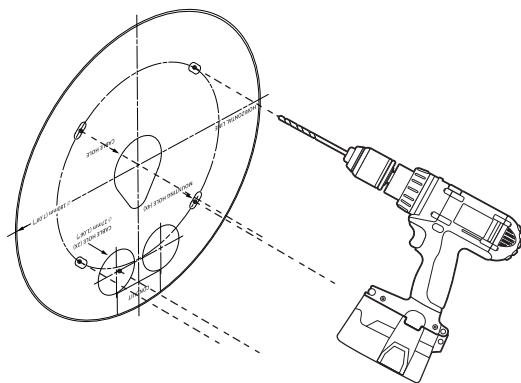

6

- Přímá instalace na zeď/strop

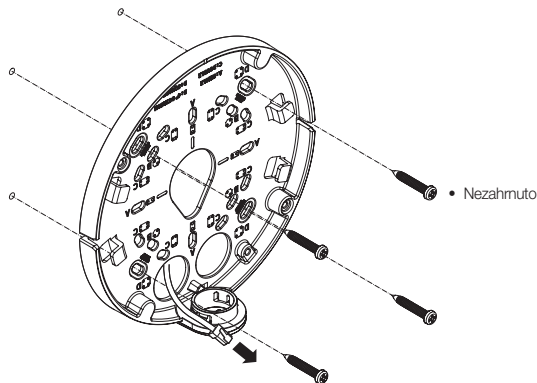

8

INSTALLATION

8-1

- Instalace kabelů LAN/napájení

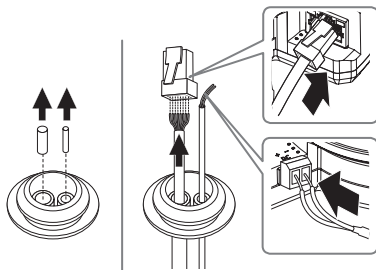

8-2

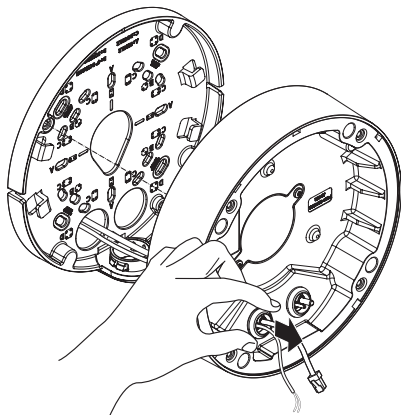

INSTALLATION

9-1

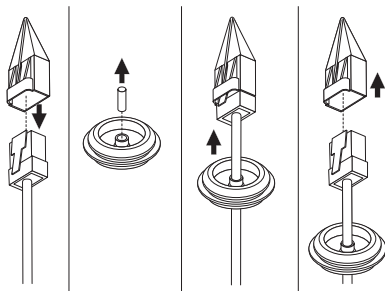

9-2

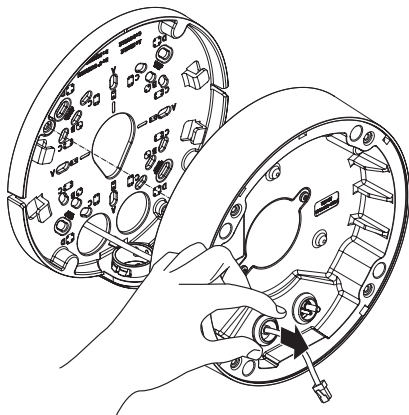

INSTALLATION

10

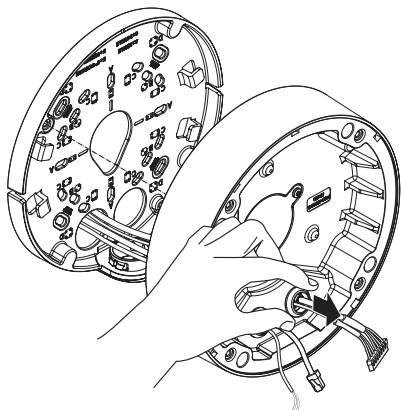

11

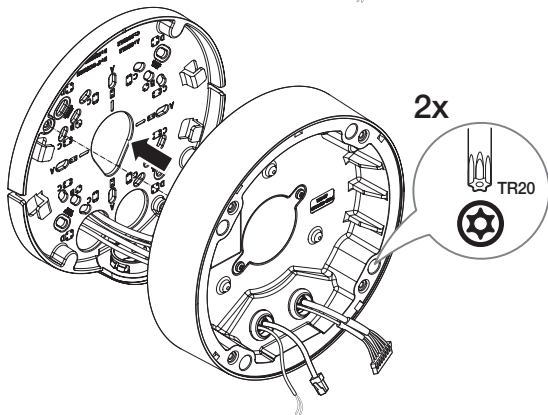

12

INSTALLATION

12

- Nezahmuto: Kľičenka Wi-Fi, adaptér OTG

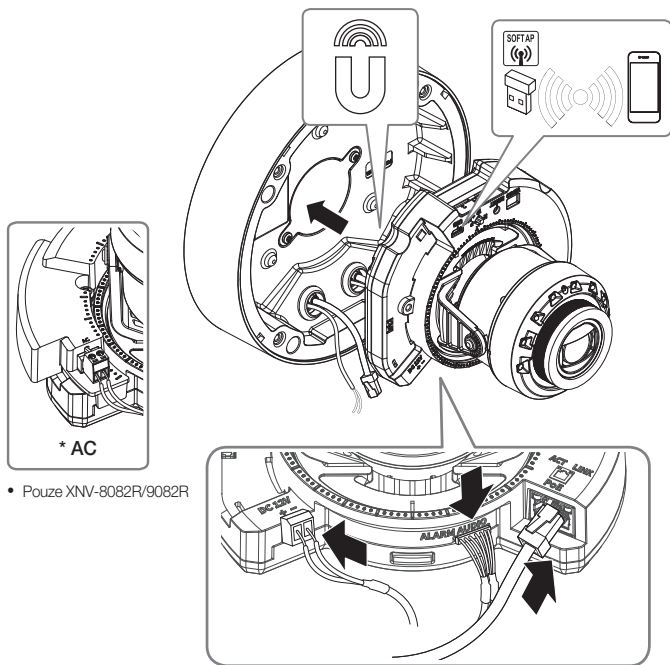

INSTALLATION

13



14

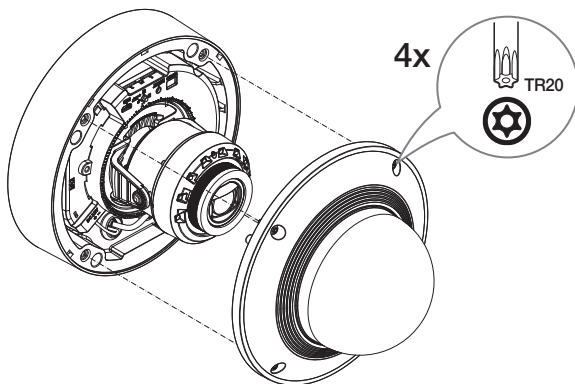

14

INSTALLATION

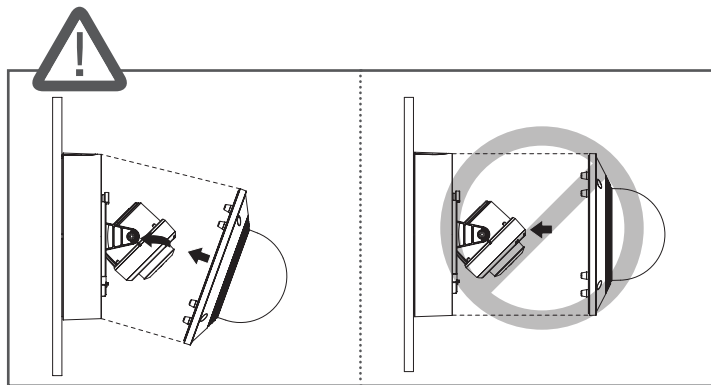

15-1 • Použití ochranné krytky

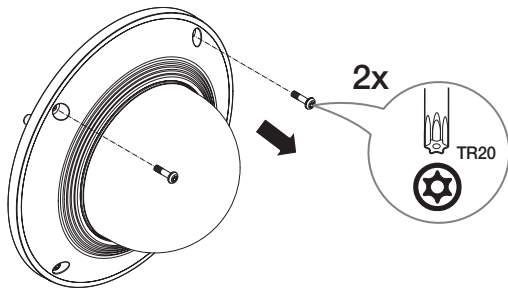

INSTALLATION

15-2

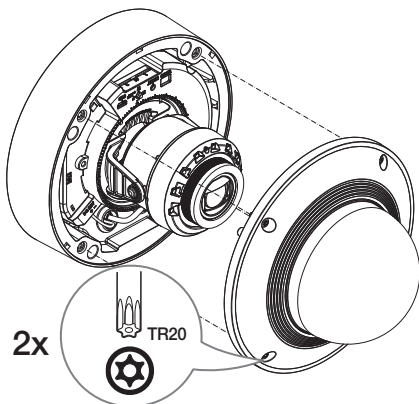

15-3

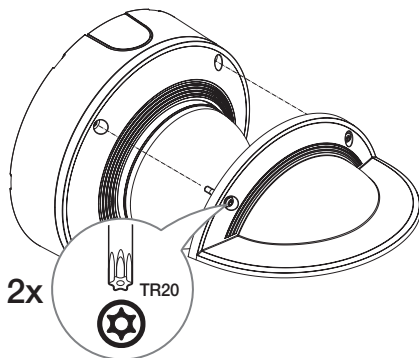



COMPONENT

Příslušenství není pro všechny země prodeje stejné.

- XND-6083RV/XND-8082RV/XND-8083RV/XND-8093RV/XND-9082RV/XND-9083RV

* Tvar modulu se může u jednotlivých produktů lišit.



Modul

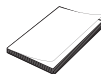

i Možnosti (nejdou uvedeny)

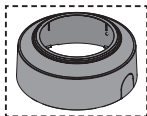

SBC-160B
(Barva: černá)

INSTALLATION

1

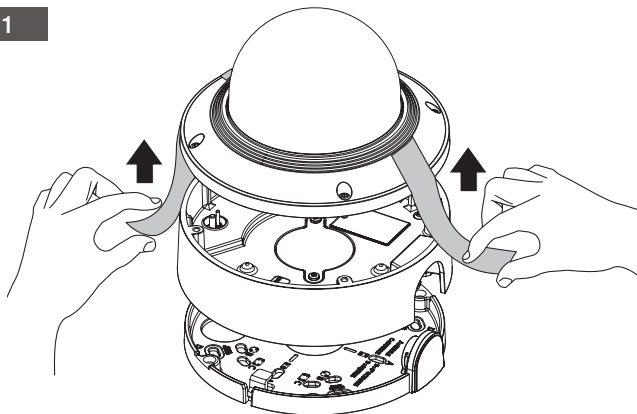

2

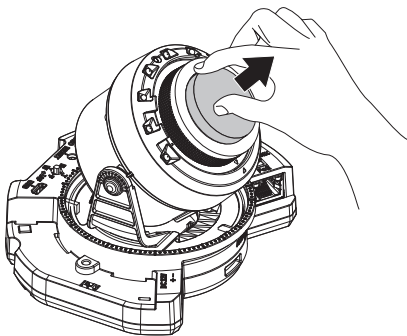

INSTALLATION

3

- Nezahrnuto: Micro SD karta

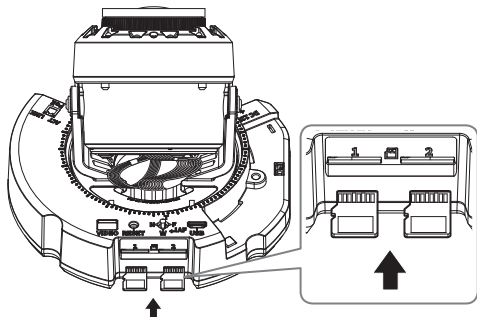

4

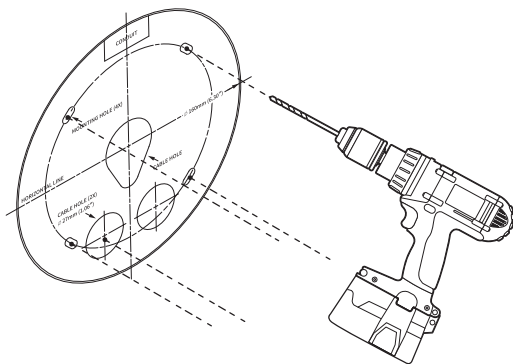

INSTALLATION

5

- Přímá instalace na zeď/strop

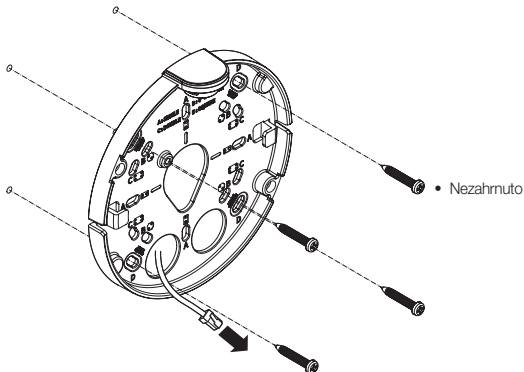

6-1

- Instalace pomocí trubky

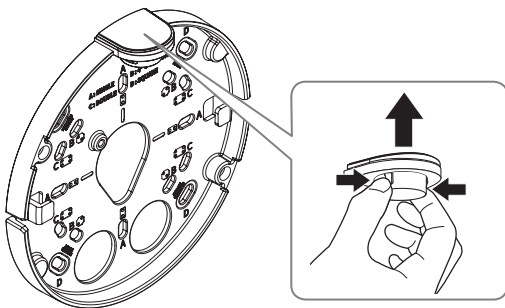

INSTALLATION

6-2

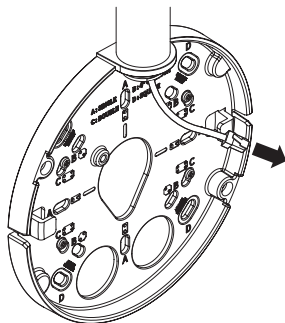

7-1

- Instalace kabelů LAN/napájení

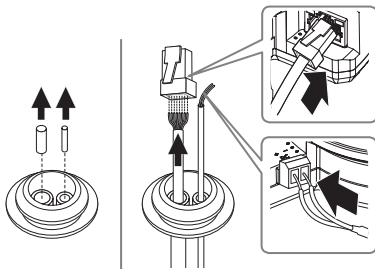

INSTALLATION

7-2

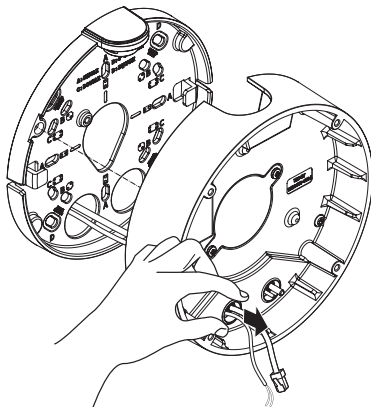

8-1

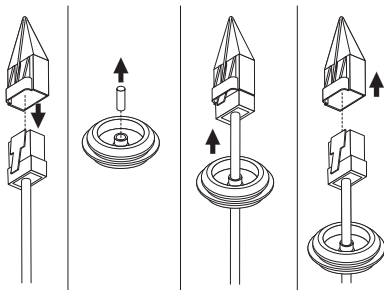

INSTALLATION

8-2

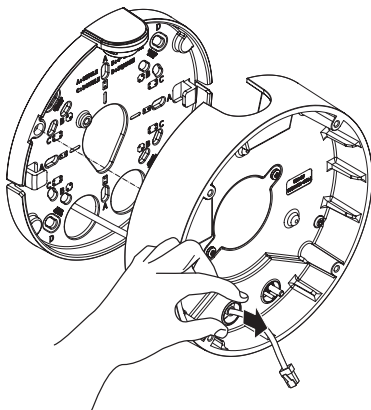

9

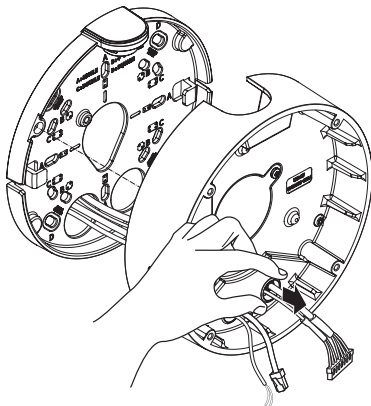

INSTALLATION

10

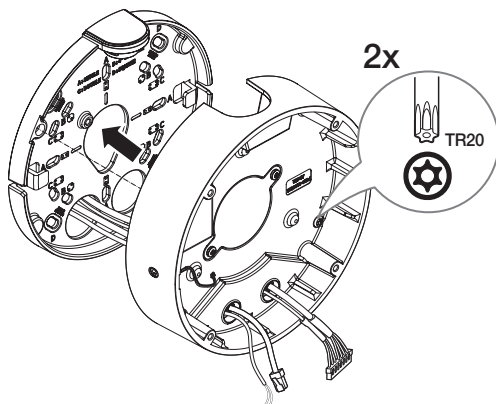

INSTALLATION

11

- Nezahrnuto: Kličénka Wi-Fi, adaptér OTG

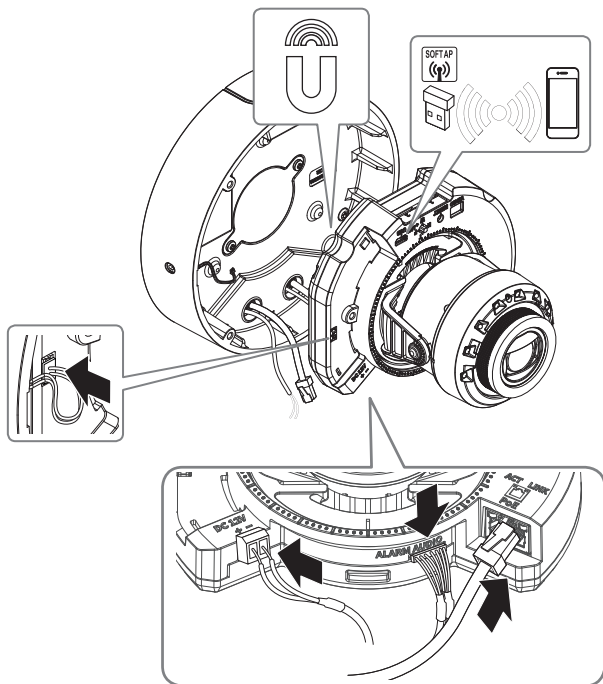

INSTALLATION

12



13

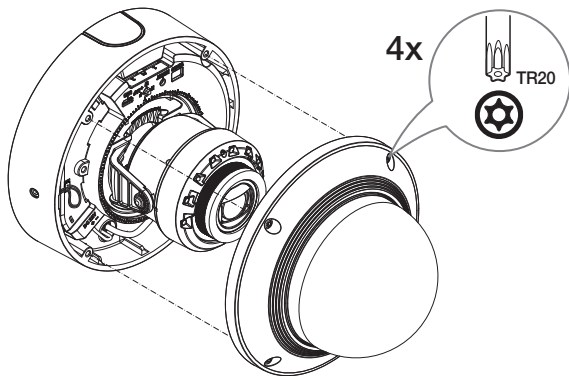

INSTALLATION

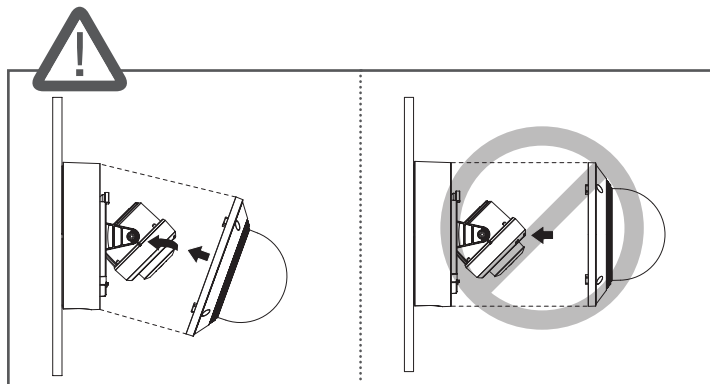

14



COMPONENT

Příslušenství není pro všechny země prodeje stejné.

- XND-8082RF/XND-9082RF

* Tvar modulu se může u jednotlivých produktů lišit.

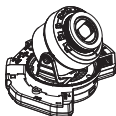
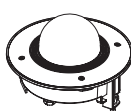

Modul

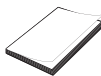
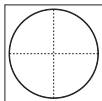

INSTALLATION

1

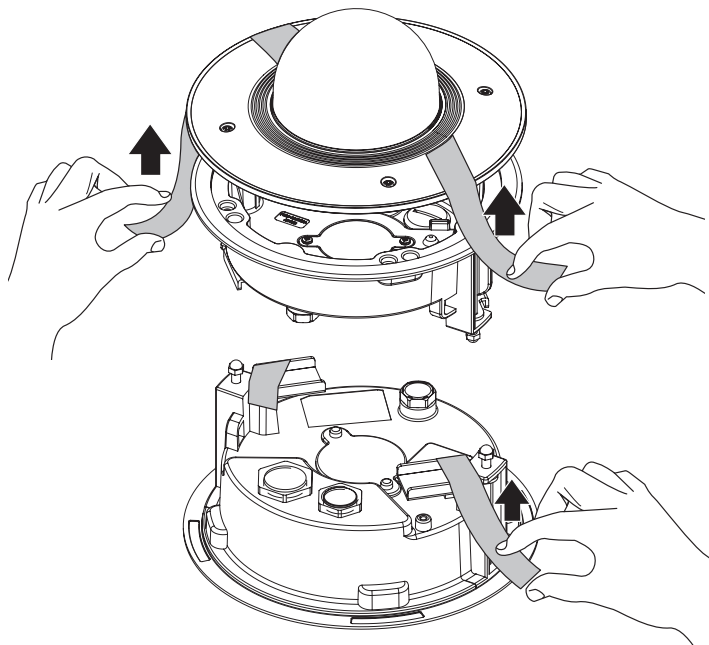

INSTALLATION

2

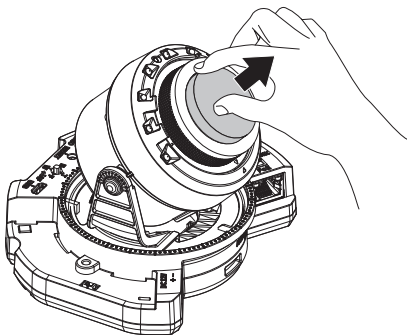

3

- Nezahmuto: Micro SD karta

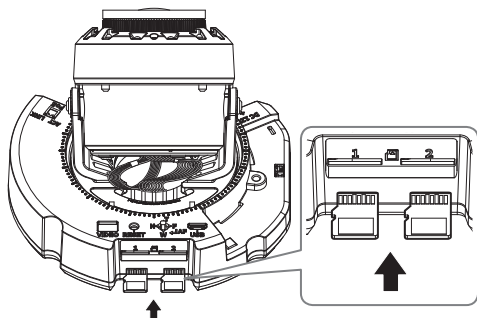

INSTALLATION

4

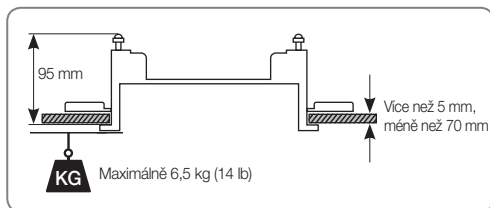
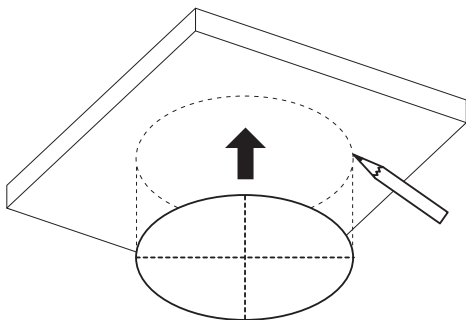

INSTALLATION

5

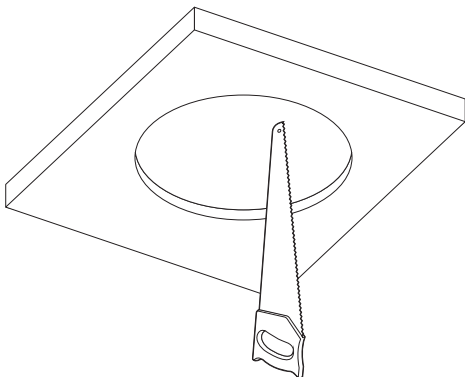

6

- Nezahmuto: Bezpečnostní kabel

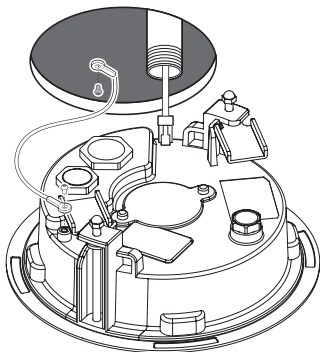
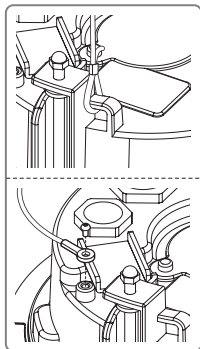

INSTALLATION

7

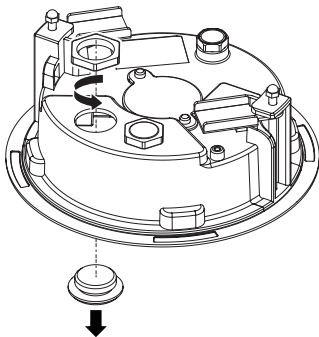

8

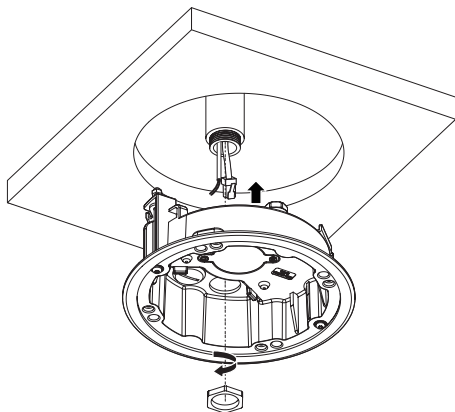

INSTALLATION

9-1

- Instalace kabelů LAN/hapájení

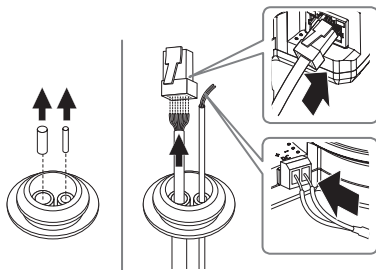

9-2

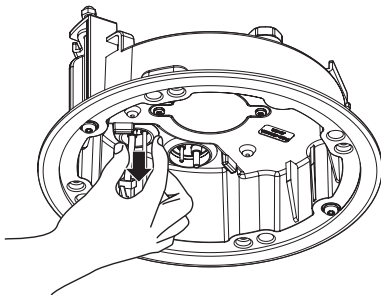

INSTALLATION

10-1

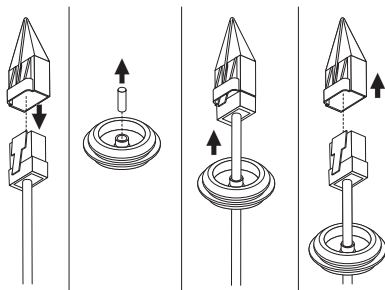

10-2

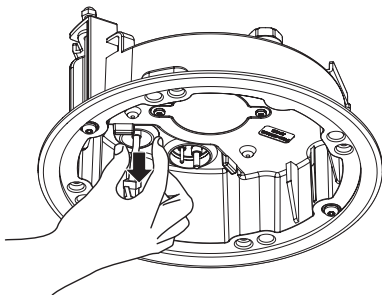

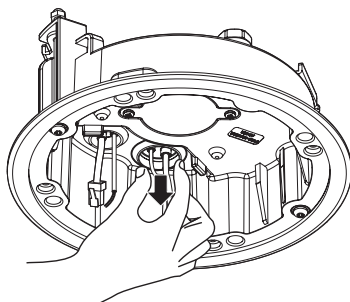

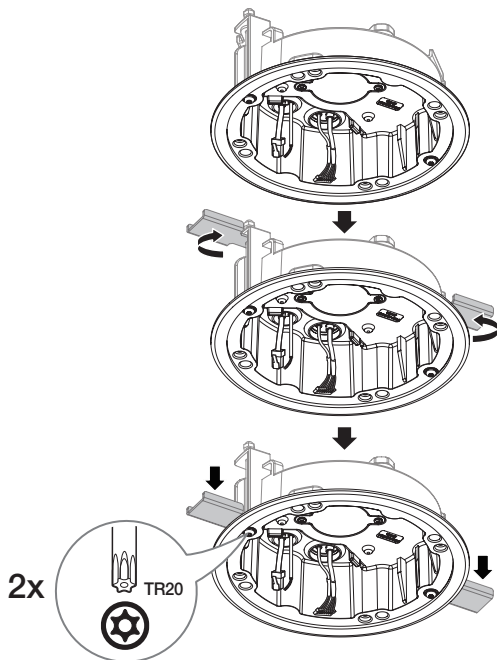

INSTALLATION

13

- Nezahmuto: Kľíčenka Wi-Fi, adaptér OTG

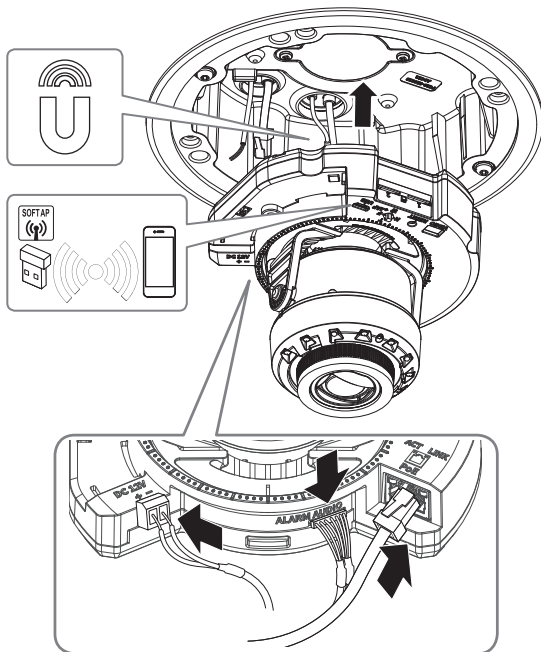

INSTALLATION

14



15

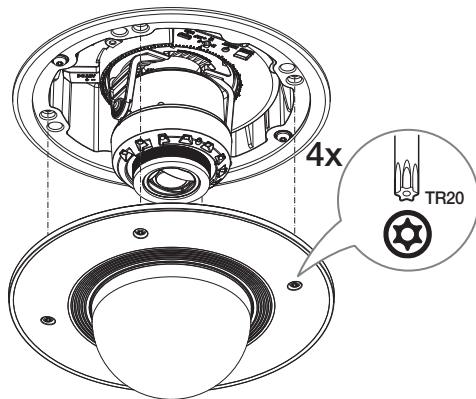

40

INSTALLATION

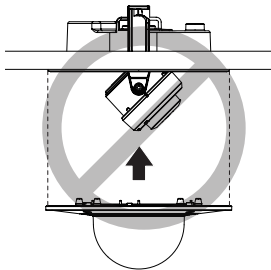
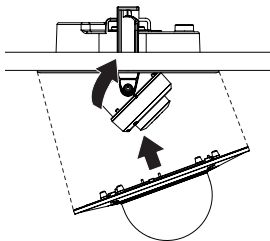

16

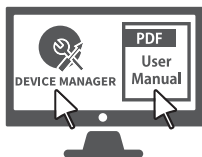

INSTALLATION

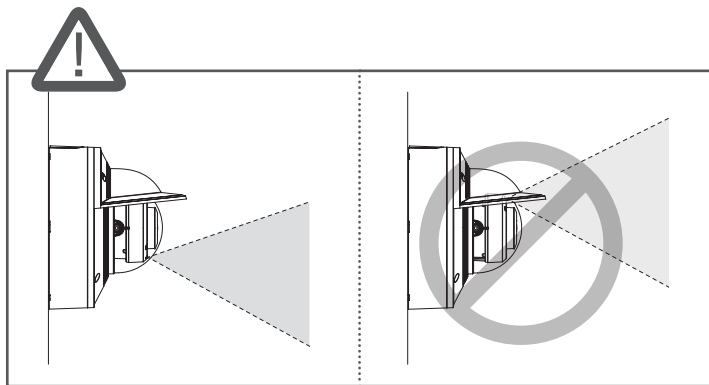
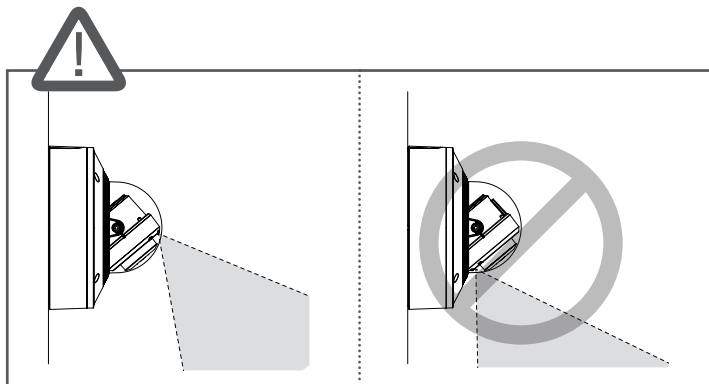

NASTAVENÍ HESLA

Při prvním otevření produktu musíte zaregistrovat přihlašovací heslo.

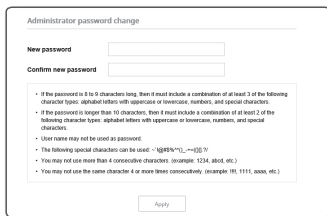

Administrator password change

New password

Confirm new password

- If the password is 8 to 16 characters long, then it must include a combination of at least 3 of the following character types: alphabet letters with uppercase or lowercase, numbers, and special characters.
- If the password is longer than 10 characters, then it must include a combination of at least 2 of the following character types: alphabet letters with uppercase or lowercase, numbers, and special characters.
- User name may not be used as password.
- The following special characters can be used: "<@#%"^*_~+=|[]?</p></div>"

Apply



- U nového hesla s 8 nebo 9 znaky musíte použít alespoň 3 z následujících: velká písmen/malá písmena, čísla a speciální znaky. U hesla s 10 až 15 znaky musíte použít alespoň 2 typy z dříve uvedeného.
 - Povolené speciální znaky: ~!@#%[^]*()_⁺=|[][.]/?
- Pro vyšší zabezpečení nedoporučujeme při zadávání hesla opakovat stejné znaky nebo po sobě jdoucí klávesy.
- Pokud jste ztratili své heslo, stiskněte tlačítko [RESET] a spustíte produkt. Neztraťte tedy své heslo, použijte poznámkový blok nebo si ho zapamatujte.

PŘIHLÁŠENÍ

Při pokusu o přístup ke kameře se zobrazí okno pro přihlášení.
Pro přístup ke kameře zadejte uživatelské jméno a heslo.

- 1 Vepište „admin“ do vstupního pole <User Name>.
- 2 Zadejte heslo do pole <Password>.
- 3 Klepněte na tlačítko [Sign in].

PŘIPOJOVÁNÍ K WiFi

Nastavení kamery

- 1 Zapojte adaptér OTG (5pinový) a klíč WiFi do konektoru microUSB.

Nastavení smartphonu

- 1 Proveďte instalaci instalační aplikace Wisenet.
- 2 Po zapnutí WiFi vyberte SSID kamery.
- 3 Spust'ete instalační aplikaci Wisenet.
- 4 Když se přihlásíte ke kameře, video se připojí.
 - Video se bude během původního připojení přehrávat bez přihlášení.
- 5 Během sledování videa na smartphonu můžete nastavit úhel zobrazení.



microSD, microSDHC, and microSDXC Logos are trademarks of SD-3C LLC. microSD, microSDHC, microSDXC are trademarks or registered trademarks of SD-3C, LLC in the United States, other countries or both.



Подлежит использованию по назначению
в нормальных условиях
Срок службы : 7 лет.

Türkiye Distribütörü

EDS Elektronik Destek Sanayi ve Ticaret Ltd. Şti.

Meclis Mah. Teraziler Cad. Hayran Sk. (Eskisi Kılıç Sk.) No: 4 Sancaktepe / İstanbul / Türkiye
Tel +90.216.313.25.15

ENTES ELEKTRONİK CİHAZLAR İMALAT VE TİC. A.Ş.

Dudullu Org.San.Bölg. 1. Cad. No:23 34776 Ümraniye / İstanbul / Türkiye
Tel +90.216.313.01.10

TEKNOMAKS TEKNOLOJİ / TEKNOMAKS BİLİSİM

MERDİVENKÖY MAH.DİKYOL SOK. BUSINESS İSTANBUL No:2, Kat:7, D:B67, 34732 Kadıköy / İstanbul / Türkiye
Tel +90.212.217.54.22

Cihazın Ticaret Bakanlığına önerilen ortalama ömrü

Cihazın EEE yönetmeliklerine uygun olduğuna benzer beyan

