

CÁMARA DE RED

Manual de consulta rápida

XNV-6083R/XNV-8082R/XNV-8083R/
XNV-8093R/XNV-9082R/XNV-9083R/
XND-6083RV/XND-8082RV/XND-8083RV/
XND-8093RV/XND-9082RV/XND-9083RV/
XND-8082RF/XND-9082RF



Important

Please check 'Manuals' from our website, before connecting to the Supply,
<https://www.hanwhavision.com/en/download-data/>

Warranty

Please check "Product warranty information" from our website.
<https://www.hanwhavision.com/en/support/warranty/>

We recommend to use the officially compatible VMS version or latest Hanwha NVR version when integrating with VMS or Hanwha NVR.



Hanwha Vision cares for the environment at all product manufacturing stages, and is taking measures to provide customers with more environmentally friendly products.

The Eco mark represents Hanwha Vision's devotion to creating environmentally friendly products, and indicates that the product satisfies the EU RoHS Directive.



Correct Disposal of This Product (Waste Electrical & Electronic Equipment)

(Applicable in the European Union and other European countries with separate collection systems)

This marking on the product, accessories or literature indicates that the product and its electronic accessories (e.g. charger, headset, USB cable) should not be disposed of with other household waste at the end of their working life. To prevent possible harm to the environment or human health from uncontrolled waste disposal, please separate these items from other types of waste and recycle them responsibly to promote the sustainable reuse of material resources.

Household users should contact either the retailer where they purchased this product, or their local government office, for details of where and how they can take these items for environmentally safe recycling.

Business users should contact their supplier and check the terms and conditions of the purchase contract. This product and its electronic accessories should not be mixed with other commercial wastes for disposal.



Correct disposal of batteries in this product

(Applicable in the European Union and other European countries with separate battery return systems.)

This marking on the battery, manual or packaging indicates that the batteries in this product should not be disposed of with other household waste at the end of their working life. Where marked, the chemical symbols Hg, Cd or Pb indicate that the battery contains mercury, cadmium or lead above the reference levels in EC Directive 2006/66. If batteries are not properly disposed of, these substances can cause harm to human health or the environment.

To protect natural resources and to promote material reuse, please separate batteries from other types of waste and recycle them through your local, free battery return system.

SAFETY INFORMATION



**Cámara Domo exterior
antivandalismo**

XNV-6083R/XNV-8082R/
XNV-8083R/XNV-8093R/
XNV-9082R/XNV-9083R

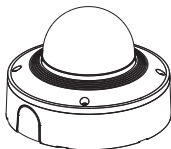

Cámara Domo interior

XND-6083RV/XND-8082RV/
XND-8083RV/XND-8093RV/
XND-9082RV/XND-9083RV

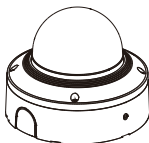

**Cámara Domo de montaje
empotrado**

XND-8082RF/XND-9082RF

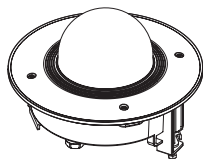

COMPONENT

Debido a los diferentes países de venta, los accesorios no son los mismos.

- XNV-6083R/XNV-8082R/XNV-8083R/XNV-8093R/XNV-9082R/XNV-9083R

* La forma del módulo puede variar según el producto.

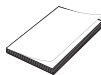
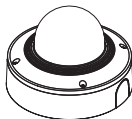

Módulo



Opciones (no incluidas)

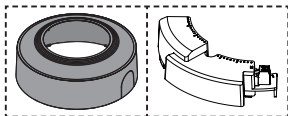

SBC-180B
(Color: Negro)

SPC-100AC
Solo XNV-8082R/
XNV-9082R

INSTALLATION

1

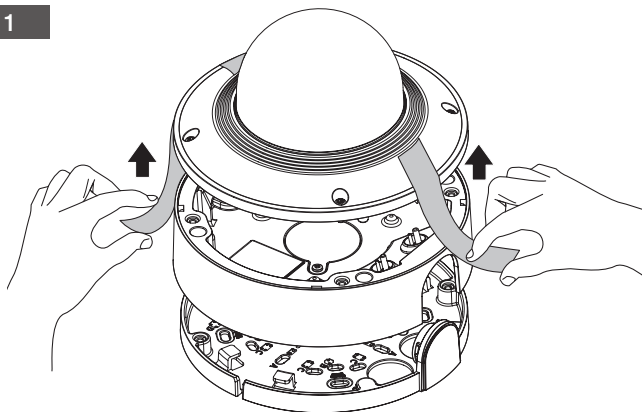

2

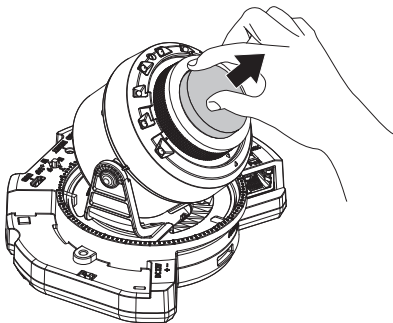

INSTALLATION

3

- No se incluye: Tarjeta Micro SD

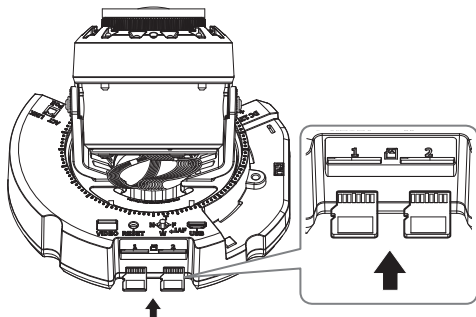

4

- No se incluye: SPC-100AC (Solo XNV-8082R/9082R)

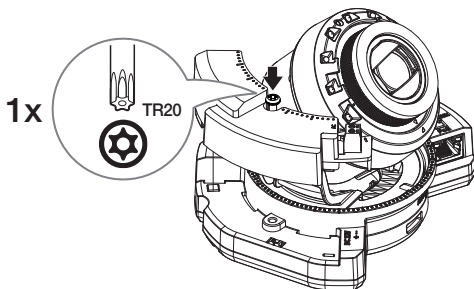

INSTALLATION

5

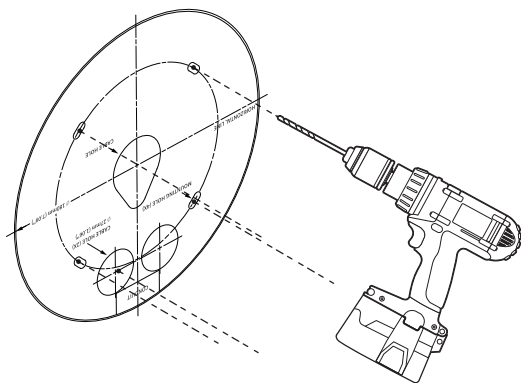

6

- Instalación directa en muro/techo

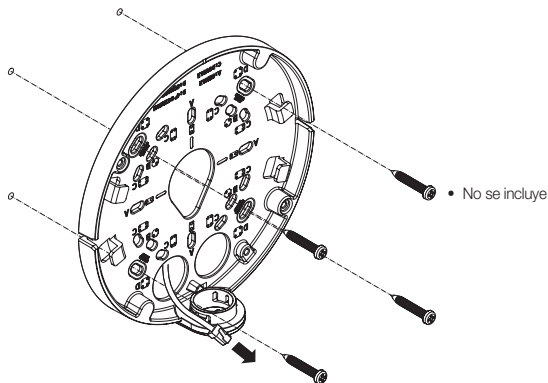

8

INSTALLATION

8-1

- Instalación de cables de red y de alimentación

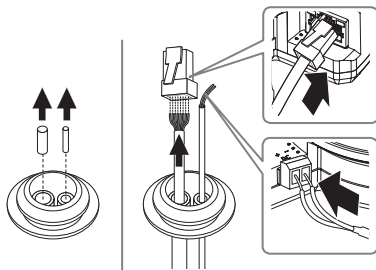

8-2

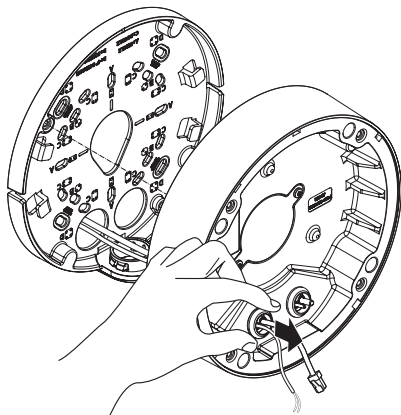

INSTALLATION

9-1

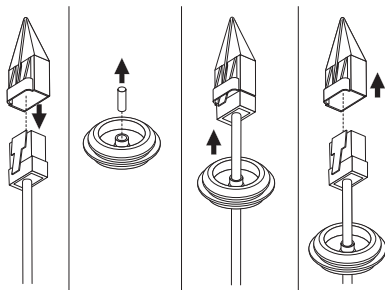

9-2

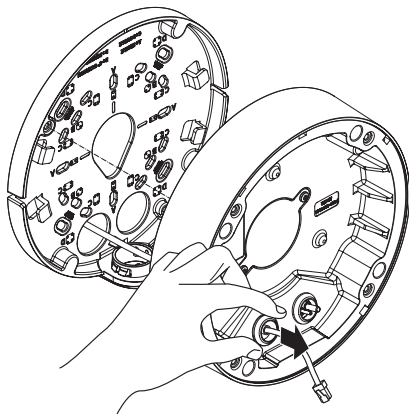

INSTALLATION

10

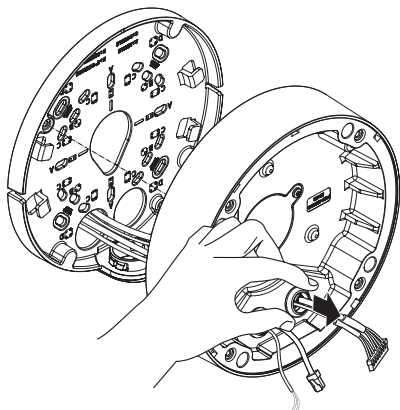

11

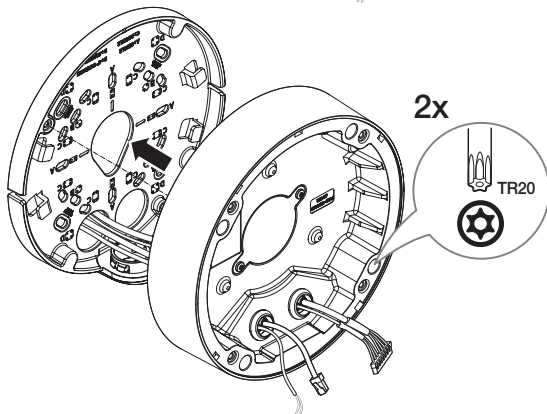

12

INSTALLATION

12

- No se incluye: Dongle WiFi, adaptador OTG

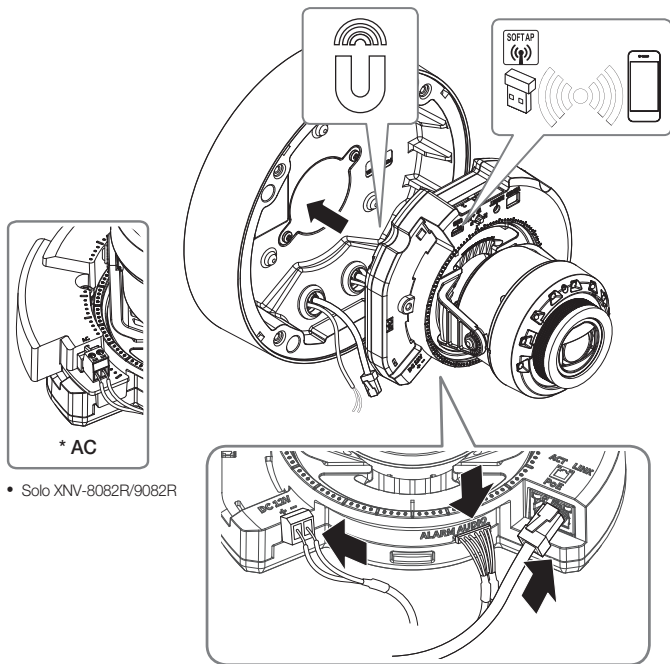

- Solo XNV-8082R/9082R

INSTALLATION

13



14

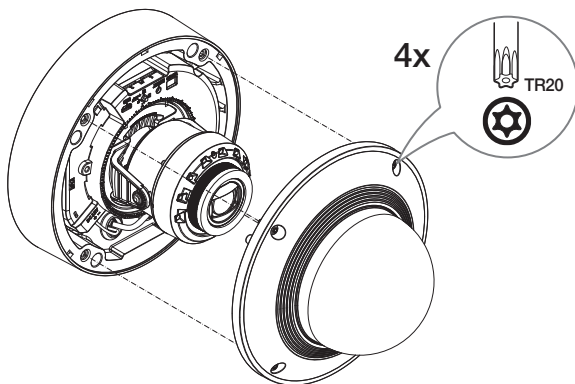

14

INSTALLATION

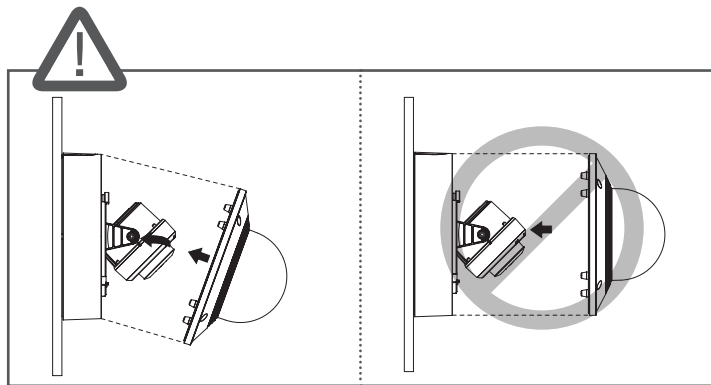

15-1 • Usar la tapa del clima

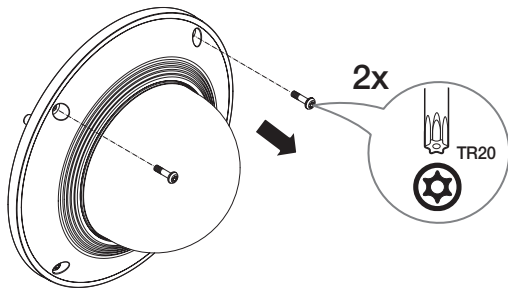

INSTALLATION

15-2

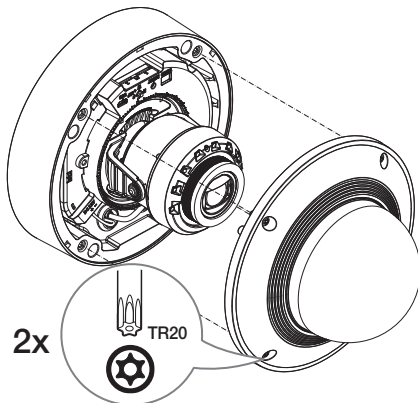

15-3

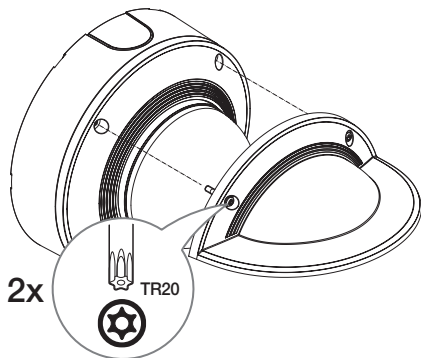



COMPONENT

Debido a los diferentes países de venta, los accesorios no son los mismos.

- XND-6083RV/XND-8082RV/XND-8083RV/XND-8093RV/XND-9082RV/XND-9083RV

* La forma del módulo puede variar según el producto.

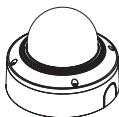

Módulo

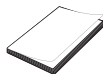

I Opciones (no incluidas)

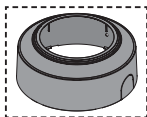

SBC-160B
(Color: Negro)

INSTALLATION

1

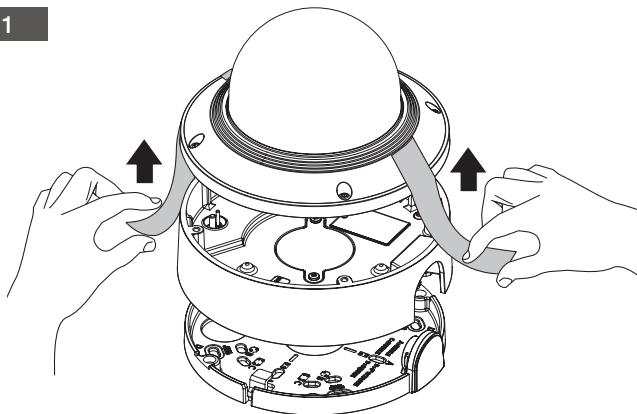

2

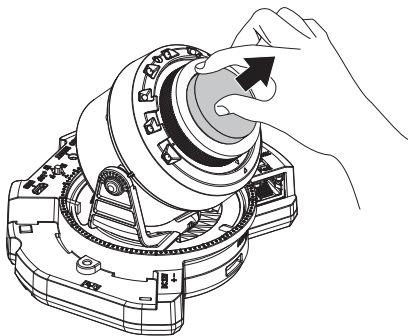

INSTALLATION

3

- No se incluye: Tarjeta Micro SD

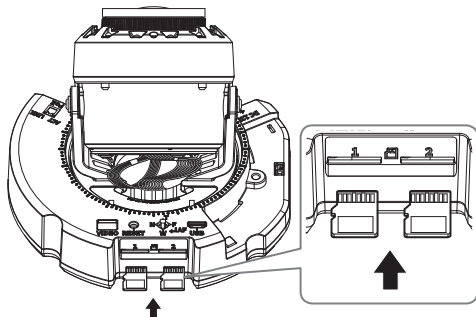

4

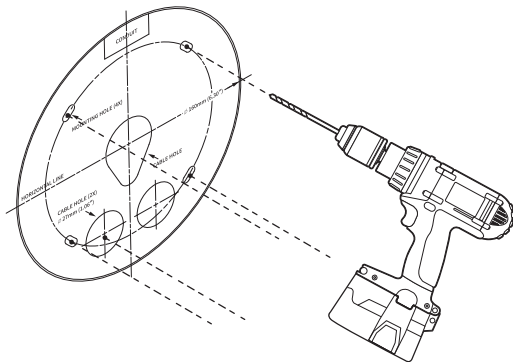

INSTALLATION

5

- Instalación directa en muro/techo

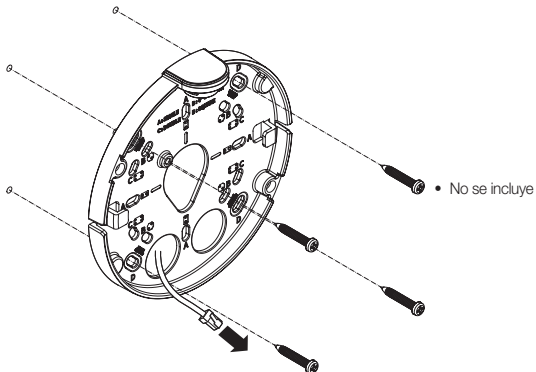

6-1

- Instalación usando tubería

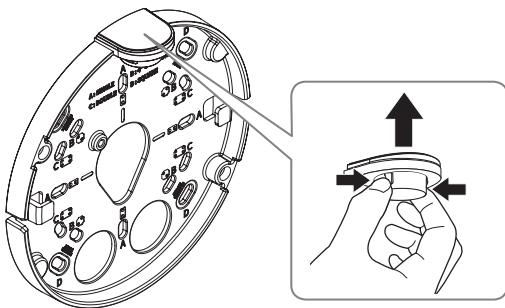

INSTALLATION

6-2

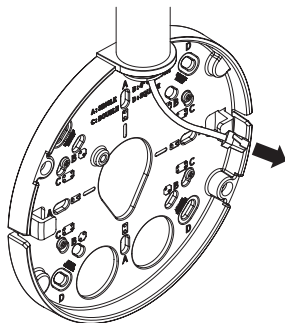

7-1

- Instalación de cables de red y de alimentación

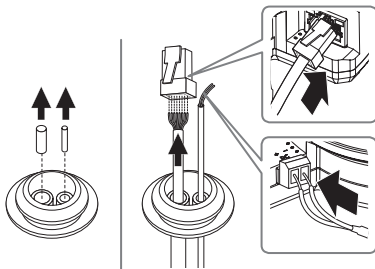

INSTALLATION

7-2

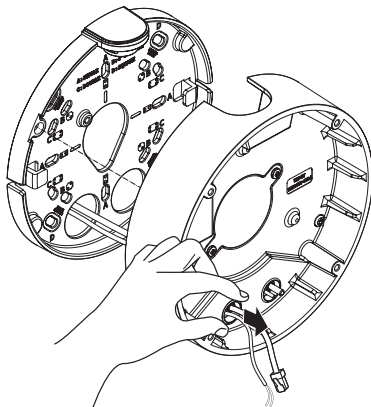

8-1

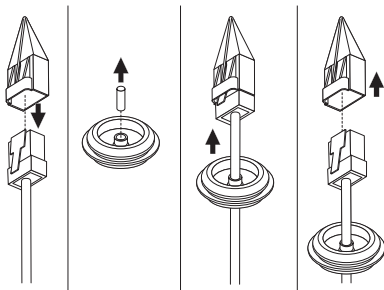

INSTALLATION

8-2

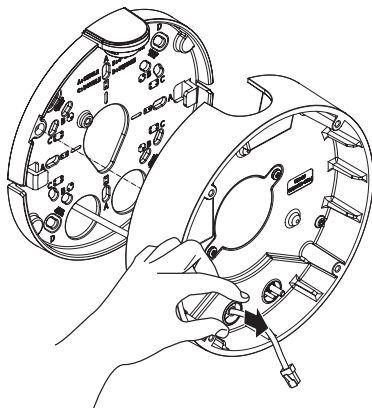

9

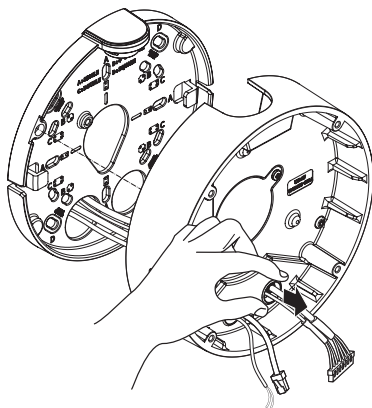

INSTALLATION

10

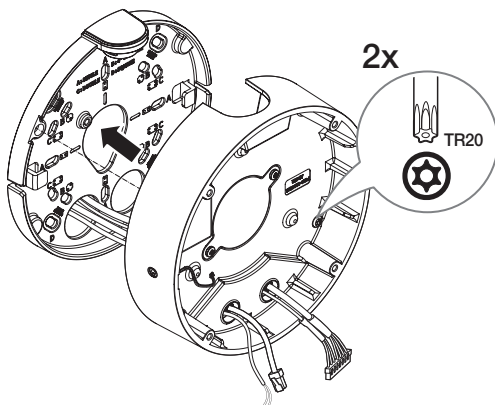

INSTALLATION

11

- No se incluye: Dongle WiFi, adaptador OTG

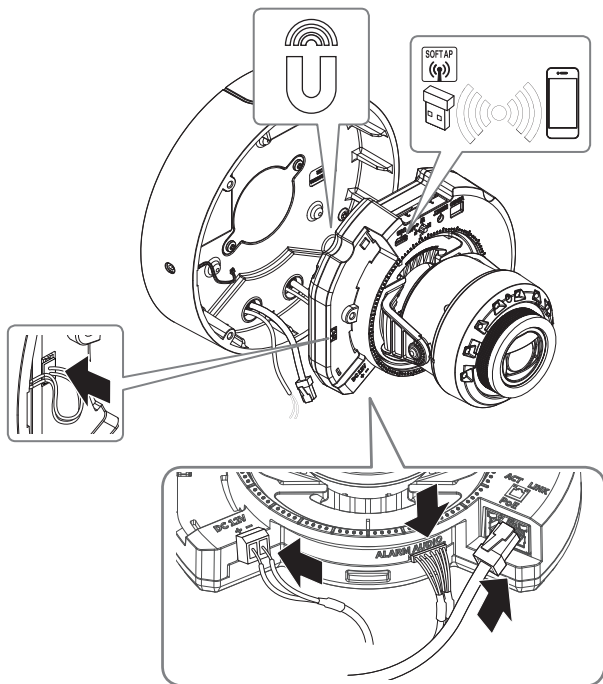

INSTALLATION

12



13

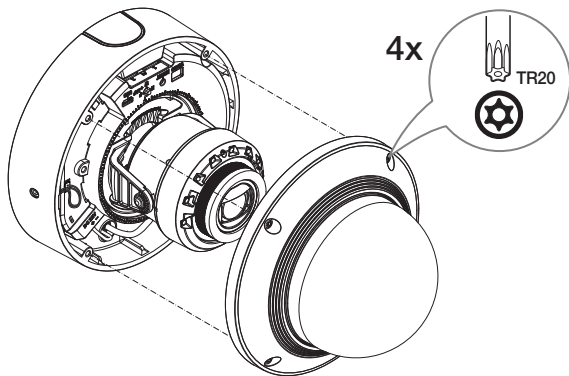

INSTALLATION

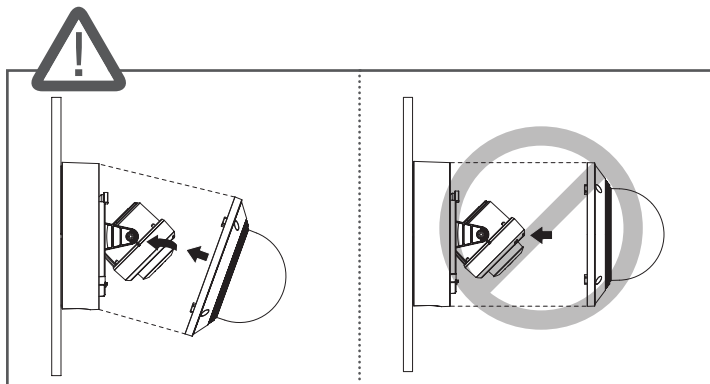

14



COMPONENT

Debido a los diferentes países de venta, los accesorios no son los mismos.

- XND-8082RF/XND-9082RF

* La forma del módulo puede variar según el producto.

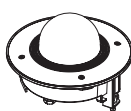

Módulo

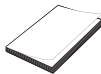
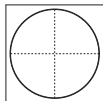

INSTALLATION

1

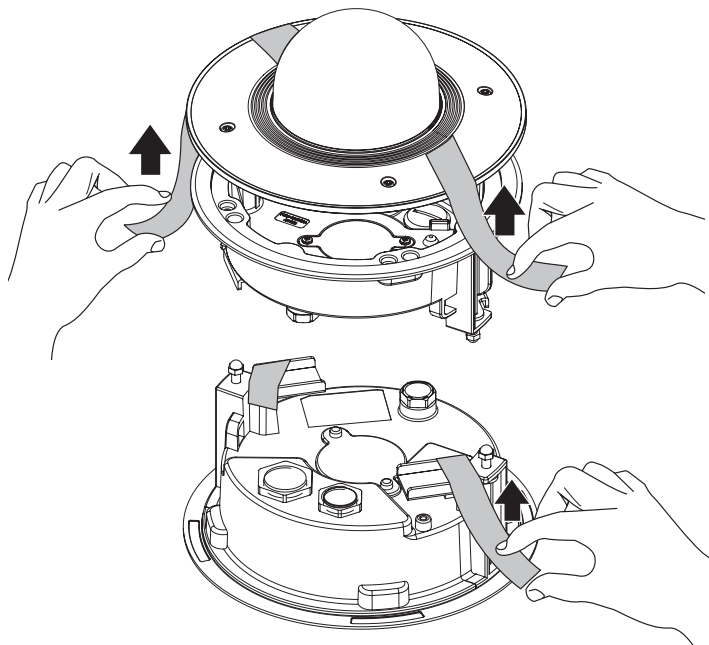

INSTALLATION

2

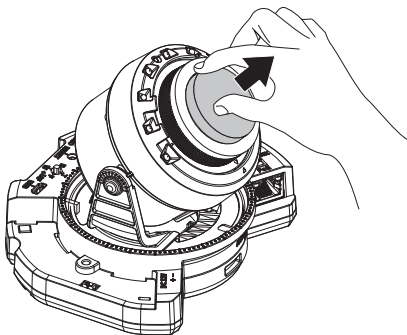

3

- No se incluye: Tarjeta Micro SD

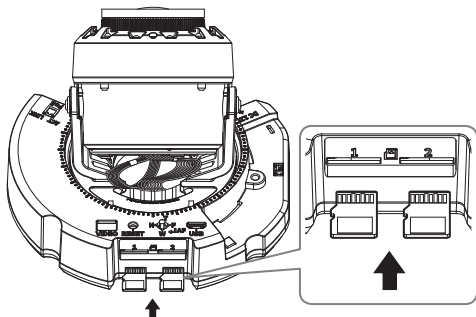

INSTALLATION

4

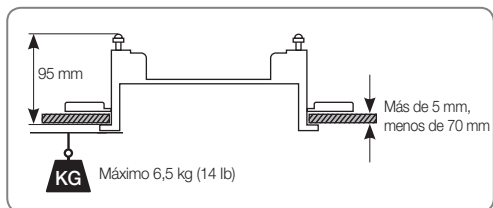
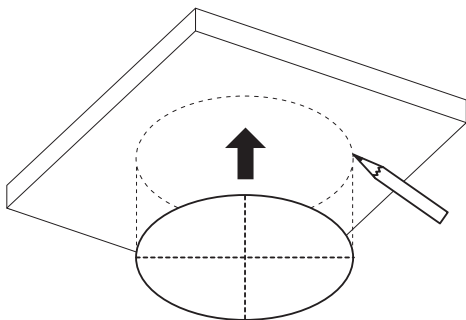

INSTALLATION

5

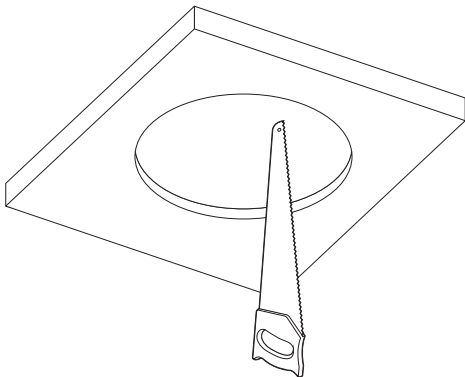

6

- No se incluye: Cable de seguridad

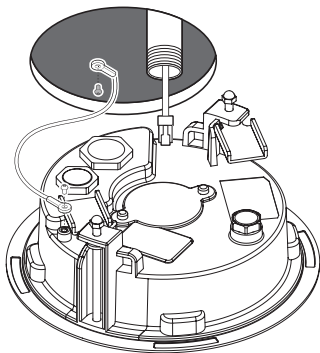
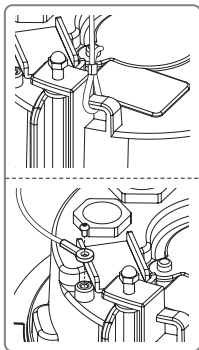

INSTALLATION

7

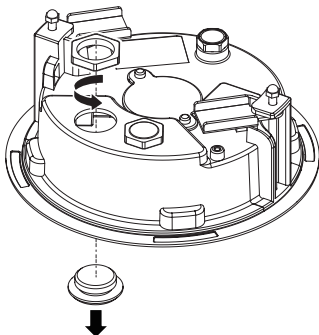

8

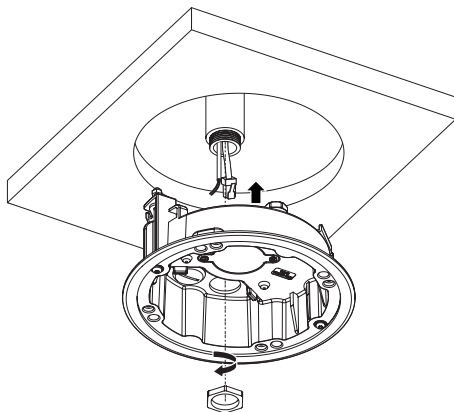

INSTALLATION

9-1

- Instalación de cables de red y de alimentación

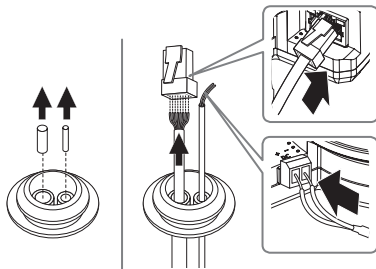

9-2

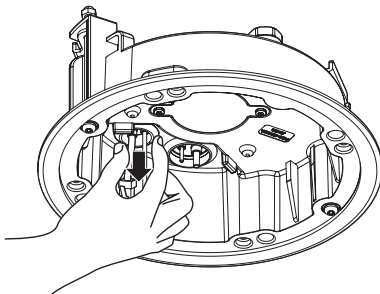

INSTALLATION

10-1

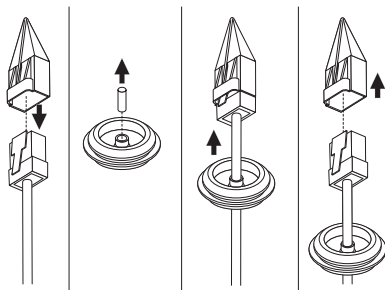

10-2

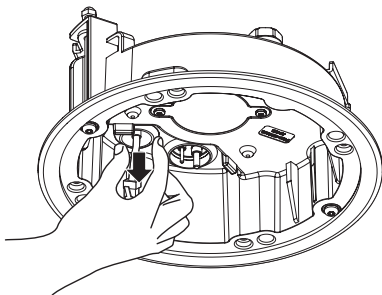

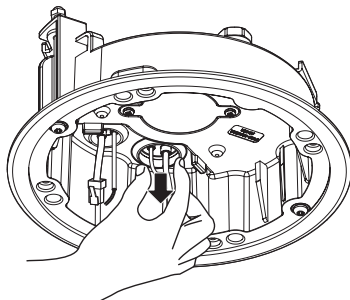

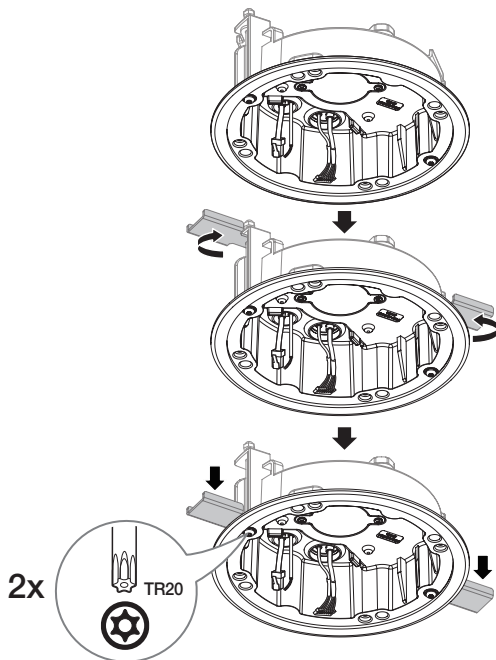

INSTALLATION

13

- No se incluye: Dongle WiFi, adaptador OTG

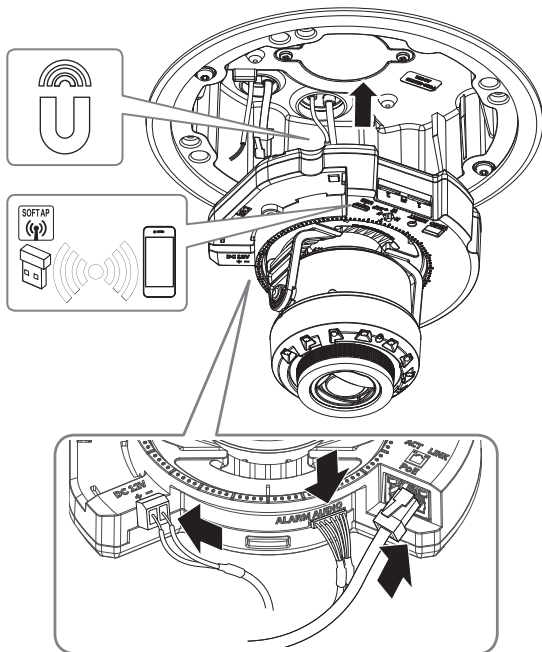

INSTALLATION

14



15

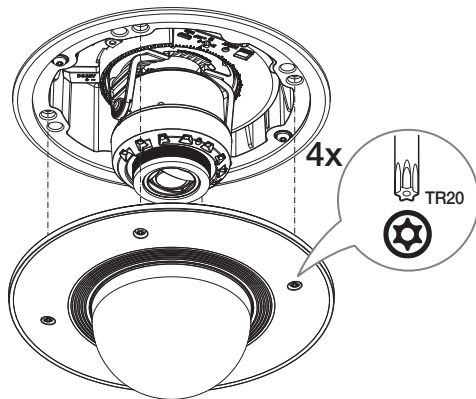

40

INSTALLATION

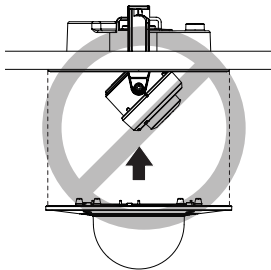
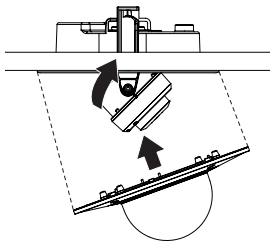

16

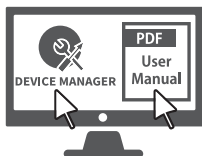

INSTALLATION

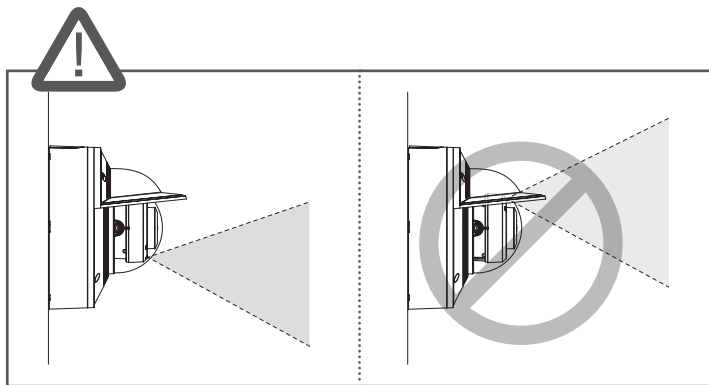
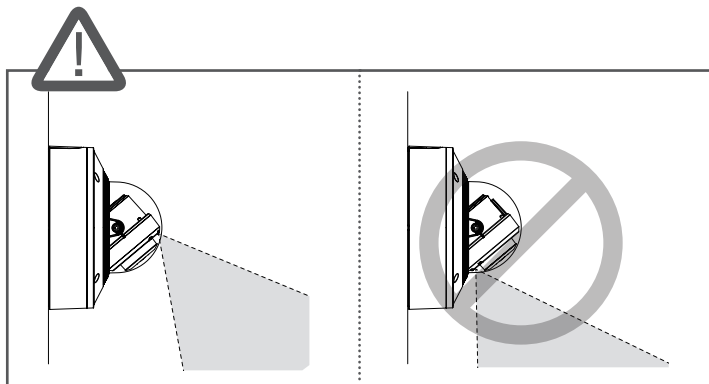

CONFIGURACIÓN DE CONTRASEÑA

Al acceder al producto por primera vez, debe registrar la contraseña de inicio de sesión.



- Para una nueva contraseña que tenga entre 8 y 9 dígitos, debe utilizar por lo menos 3 mayúsculas/ minúsculas, 3 números y 3 caracteres especiales. Para una contraseña que tenga entre 10 y 15 dígitos, debe utilizar por lo menos 2 de los tipos mencionados.
 - Caracteres especiales que se permiten: ~!@#\$%^&*()_-=+{}[]?/
- Para mayor seguridad, no se recomienda repetir los mismos caracteres ni entradas consecutivas de teclado en las contraseñas.
- Si ha perdido su contraseña, puede pulsar el botón **[RESET]** para iniciar el producto. Así pues, no pierda la contraseña utilizando un bloc de notas o memoricela.

INICIO DE SESIÓN

Siempre que acceda a la cámara, aparecerá la ventana de inicio de sesión. Introduzca el ID de usuario y la contraseña para acceder a la cámara.

- 1 Introduzca **"admin"** en el cuadro de entrada **<User Name>**.
- 2 Introduzca la contraseña en el campo de entrada **<Password>**.
- 3 Haga clic en **[Sign in]**.

CONEXIÓN A WIFI

Ajuste de la cámara

- 1 Conecte el adaptador OTG (5 pines) y el dongle WiFi al terminal micro USB.

Configuración del teléfono inteligente

- 1 Instale la aplicación de instalación de Wisenet.
- 2 Seleccione el SSID de la cámara después de encender el WiFi.
- 3 Ejecute la aplicación de instalación de Wisenet.
- 4 Cuando inicie sesión en la cámara, se conectará el vídeo.
 - El vídeo se reproducirá sin estar conectado durante la conexión inicial.
- 5 Puede ajustar el ángulo de visión mientras ve el vídeo a través del smartphone.



microSD, microSDHC, and microSDXC Logos are trademarks of SD-3C LLC. microSD, microSDHC, microSDXC are trademarks or registered trademarks of SD-3C, LLC in the United States, other countries or both.



Подлежит использованию по назначению
в нормальных условиях
Срок службы : 7 лет.

Türkiye Distribütörü

EDS Elektronik Destek Sanayi ve Ticaret Ltd. Şti.

Meclis Mah. Teraziler Cad. Hayran Sk. (Eskisi Kılıç Sk.) No: 4 Sancaktepe / İstanbul / Türkiye
Tel +90.216.313.25.15

ENTES ELEKTRONİK CİHAZLAR İMALAT VE TİC. A.Ş.

Dudullu Org.San.Bölg. 1. Cad. No:23 34776 Ümraniye / İstanbul / Türkiye
Tel +90.216.313.01.10

TEKNOMAKS TEKNOLOJİ / TEKNOMAKS BİLİSİM

MERDİVENKÖY MAH.DİKYOL SOK. BUSINESS İSTANBUL No:2, Kat:7, D:B67, 34732 Kadıköy / İstanbul / Türkiye
Tel +90.212.217.54.22

Cihazın Ticaret Bakanlığına önerilen ortalama ömrü

Cihazın EEE yönetmeliklerine uygun olduğuna benzer beyan

